



RFP FOR CIVIL, PLUMBING AND REPAIR/RENOVATION WORKS AT
KARNATAKA GRAMEENA BANK, HEAD OFFICE-ANNEX, DHARWAD

TENDER REF: KGB/GA/CIVIL/04/2026-27 DATED 21.04.2026

LAST DATE TO SUBMIT APPLICATION: 13.05.2026

For details log on to Bank Website <https://karnatakagb.bank.in/> or contact the below mentioned office.

General Administration Wing
Gandhinagara, Head Office,
Ballari - 583 103

Phone: 08392-236430/428
email: psitw.premises@kgbk.in



NOTICE INVITING REQUEST FOR PROPOSAL (RFP)

CIVIL, PLUMBING WORKS AND REPAIR/RENOVATION WORKS AT KARNATAKA GRAMEENA BANK, PB NO.111, PB ROAD, NEAR NEW KSRTC BUS STAND, HEAD OFFICE-ANNEX, DHARWAD - 580001

Karnataka Grameena Bank is a Regional Rural Bank owned by Government and Sponsored by Canara Bank.

The bank intends for Civil and Repair/Renovation works for existing premises at Head office-Annex, Dharwad. Sealed bids under two bids concept (Technical Bid and Financial Bid) are invited as described in this document. A Firm submitting the proposal in response to this RFP shall hereinafter be referred to as Bidder.

1) Details of the Tender :

Name of the Work	CIVIL, PLUMBING WORKS AND REPAIR/RENOVATION WORKS
Location of Work	KARNATAKA GRAMEENA BANK, HEAD OFFICE-ANNEX, PB NO.111, PB ROAD, NEAR NEW KSRTC BUS STAND, DHARWAD - 580001
Built-up Area of Existing Building with 3 floors (Ground, First, Second)	Approx. 8,229 Sq.Ft.
Age of the Building	15 years
Earnest Money deposit	₹80,000/- (DD in favour of KARNATAKA GRAMEENA BANK payable at Ballari)
Security Deposit	2% of the contract amount(including EMD) from successful bidder before the work assignment and 8% retention money on contract amount from the first bill. Totaling 10% on contract amount.
Issue of tender document	21.04.2026
Estimated cost of the works (Excl. of GST)	Around ₹40 Lakhs
Defects Liability Period (DLP)	12 (Twelve) months from the date of Completion of the work
Last Date for Submission of Pre-Bid Queries	29.04.2026 before 12.00 pm
Pre-bid meeting	29.04.2026 at 03.30 pm
Last date for submission of Tender	13.05.2026 before 5.00 pm
Opening of Technical bids	14.05.2026 at 10.00 am
Opening of Financial bids	Date & time will be informed to the qualified bidders through e-mail.
Period of completion	90 days from the date of work order.



ಕರ್ನಾಟಕ ಗ್ರಾಮೀಣ ಬ್ಯಾಂಕ್

KARNATAKA GRAMEENA BANK

Scheduled Bank Owned by Government

ಬೆಂಗಳೂರು ಕಛೇರಿ : ಬೆಂಗಳೂರು

Head office : Ballari

Tender documents (soft copy)	Can be downloaded free of cost from Karnataka Grameena Bank's web site https://karnatakagb.bank.in/tenders & Central Public Procurement (CPPP) portal www.eprocure.gov.in from 21.04.2026 till last date of submission. Please check Bank's website regularly for any Corrigendum or other information regarding the tender during the course of the tender.
Last date and time for submission of the tender	Sealed envelopes to be submitted on or before 13.05.2026 by 5.00 PM to the office of: "KARNATAKA GRAMEENA BANK GENERAL ADMINISTRATION WING, No- 32, GANDHINAGARA, HEAD OFFICE, BALLARI - 583103, Phone: 08392- 236430/428"

**GENERAL MANAGER
GENERAL ADMINISTRATION WING
KARNATAKA GRAMEENA BANK,
HEAD OFFICE, BALLARI**

2. ELIGIBILITY CRITERIA:

The reputed firms/ companies who fulfill the following requirements are eligible to apply. The Vendor/ Companies/ Agencies having experience in the carrying out civil works in the commercial/residential building and who have executed such works are eligible to apply -

S.N	Criteria	Documents Required
1	The Bidder should be registered with a minimum of 5 years experience as on 31.03.2026 in carrying out civil works.	1. Work Order/ Work completion copies /certificates not older than 5 years from the date of this RFP. 2. Copy of Labour License issued by the Assistant labour Commissioner
2	The Bidder must have a minimum Annual Turnover of ₹25.00 lakhs during each of the last three financial years i.e. 2023-24, 2024-25, 2025-26.	1) Audited Balance Sheet and P & L Account for the last three years mentioned. 2) Certificate from Chartered Accountant for Turnover & Profit/Loss for the last three financial years i.e. 2023-24, 2024-25, 2025-26
3	The bidder should have supplied / executed/ completed similar work in Central Govt./ Sate govt./PSU/PSB or any reputed organization during the last five (5) years ending with 31.03.2026 for at least One similar work costing not less than ₹.35.00 LAKHS OR Two similar works each costing not less than ₹.18.00 LAKHS OR Three similar works each costing not less than ₹.12.00 LAKHS Note: The amount of works executed during previous years shall be increased by 5% every year till 31.03.2026 from the date of actual completion to bring it to the present value.	Work order copies and satisfactory completion certificates clearly indicating the cost & nature of work executed, date of commencement & completion issued by the Clients/ Consultants.
4	BLACKLISTING/DEBARREDNESS CERTIFICATE Bidders who have been debarred / blacklisted in other utilities in India will not be considered.	In this respect, the Bidders shall submit declaration as outlined in Appendix-8 on their Company Letter headed paper duly sealed & signed.
5	The bidders desirous of quoting should have a registered office in KARNATAKA .	Declaration from the bidder of the company signed by the competent authority in the company letter headed with details of address of office in KARNATAKA
6	The bidder must have Goods & Service tax registration number and PAN number.	Copies of the GST registration certificate and PAN card.

The Bidder should be able to provide qualified service for attending the problems if any during the Warranty/AMC period. The availability of services of the engineers in as and when required should be ensured.

Before submission of the offer, the Bidders are requested to read the following instructions and the terms and conditions.

- 1) Tender documents can be downloaded only from the Bank's website <https://karnatakagb.bank.in/tenders> & Central Public Procurement (CPP) portal www.eprocure.gov.in website free of cost. The Tender documents shall be in A-4 size paper and neatly bounded (hard bound / spiral bound) in two separate books (i.e. Technical bid and Financial bid) and submitted as detailed in clause 10 below.
- 2) Tender documents consists of Notice Inviting the Tender (NIT), Eligibility criteria, General rules and Directions to Tenderers, General Conditions of contract, Special conditions, Safety code, **Annexures**, Schedule of Quantity (SOQ).
- 3) Tenders shall be on prescribed Form for item rate tenders as issued by the Bank / hosted by the Bank in website <https://karnatakagb.bank.in/tenders> & Central Public Procurement (CPP) portal www.eprocure.gov.in
- 4) The site is ready for commencement of works.
- 5) Nature of the document: **TWO BID CONCEPT**. This Tender document comprises of the following :
 - A. TECHNICAL BID: (first envelope)** consisting of following should be hardbound/spiral bound and submitted in separate envelope-
 - a) EMD - Earnest Money Deposit
 - b) Notice inviting tender (NIT).
 - c) General Rules & Directions to contractor.
 - d) Special conditions of the Contract.
 - e) General Conditions of contract.
 - f) Safety code.
 - g) Annexures
 - B. FINANCIAL BID (second envelope):** Bill of quantity (BOQ). Financial bid to be submitted in separate envelope.
- 6) **Submission and opening of Tenders :**
 - a) Tenders on prescribed form should be placed in two envelopes one sealed envelope consisting of "Technical bid" duly super scribed as "Technical bid" and other sealed envelope consisting "Financial bid" duly super scribed as "Financial Bid" and both envelopes shall be kept in one bigger sealed single envelope, with the name of work, Name of Tenderer and due date written on the envelopes.
 - b) Sealed Tenders shall be addressed to "KARNATAKA GRAMEENA BANK, GENERAL ADMINISTRATION WING, No-32, GANDHINAGARA, HEAD OFFICE, BALLARI - 583103, Phone: 08392-236430/428".
 - c) Sealed Tenders shall be dropped in the TENDER BOX kept at the above said address or through courier/postage.
 - d) If last day for submission of tender is declared as a holiday under NI Act by the Government subsequent to issuance of tender the next working day will be deemed to be the last day for submission of the tender. The first part of tenders i.e. Technical bid will be opened on the same day and location of tender submission.
 - e) Technical bids will be evaluated based on the Bank's eligibility criteria's. Wherever contractors /agencies are submitting consolidated completion certificates, then the Bank may request for supporting documents. Bank's decision in this regard is final and

- shall be binding on all.
- f) The Financial bid of only the technically qualified / shortlisted applicants will be opened on a pre-notified time & date, under intimation to such qualified / shortlisted applicants over phone/email. Lowest quoted tender (L1) will be arrived based on the evaluation of all the financial bids and after mathematical scrutiny and freak rate analysis. Bank's reserves rights of accepting/rejecting any and all the financial bids.
- 7) The tender shall be accompanied by earnest money deposit of ₹80,000/- (**Rupees Eighty Thousand Only**) by way of Demand Draft of a Scheduled commercial Bank issued in favour of **Karnataka Grameena Bank payable at Ballari**. or can also be submitted by way of irrevocable Bank guarantee from scheduled commercial Bank other than Karnataka Grameena Bank valid for 90 days with claim period of 30 days in the format prescribed by the Bank. EMD shall be submitted with the Technical bid only and should be kept along with cover containing the Technical bids.
EMD shall be submitted with the Technical bid only and should be kept along with cover containing the Technical bids.
- Submission of EMD in the form of fixed deposit or in any other form is not acceptable and tenders with such EMD shall be rejected.**
- No interest shall be allowed on the Earnest Money Deposit (EMD). Tenders without EMD shall be summarily rejected.
- 8) Copies of other drawings and documents pertaining to the works will be open for inspection by the tenderers at the office of the above mentioned Office of the Bank.
- 9) Tenderers are advised to inspect and examine the site and its surroundings and satisfy themselves before submitting their tenders, as to the means of access to the site, the accommodation they may require and in general shall themselves obtain all necessary information as to risks, contingencies and other circumstances which may influence or affect their tender. A tenderer shall be deemed to have full knowledge of the site whether he inspects it or not and no extra charges consequent on any misunderstanding or otherwise shall be allowed. Submission of a tender by tenderers implies that he has read this notice and all other contract documents and has made himself aware of the scope and specifications of the work to be done, site details and local conditions and other factors bearing on the execution of the work.
- 10) The tenderer shall be responsible for arranging and maintaining at his own cost all materials, labour, tools and plants, water, electricity, access, facilities for workers and all other services required for executing the work unless otherwise specifically provided for in the contract documents.
- 11) Karnataka Grameena Bank reserves to itself the right of accepting the whole or any part of the tender and the tenderer shall be bound to perform the same at the rate quoted.
- 12) The tender for the works shall remain open for acceptance for a period of **90 days** from the date of opening of tenders. If any tenderer withdraws his tender before the said period or makes any modifications in the terms and conditions of the tender which are not acceptable to the Bank, then the Bank shall, without prejudice to any other right or remedy, be at liberty to forfeit full value of the earnest money as aforesaid.

- 13) This Notice Inviting Tender shall form a part of the contract document. The successful Tenderer/contractor, on acceptance of his tender by the Accepting Authority, shall, enter in to an agreement within 7 days from the date of acceptance letter.
- 14) Karnataka Grameena Bank does not bind itself to accept the lowest or any other tender, and reserves to itself the authority to reject any or all of the tenders received without the assignment of any reason. All tenders in which any of the prescribed conditions are not fulfilled or new conditions are stipulated by the tenderer or are incomplete in any respect are liable to be rejected.
- 15) Canvassing whether directly or indirectly, in connection with tenders is strictly prohibited and the tenders submitted by the contractors who resort to canvassing will be liable to rejection.
- 16) **Pre bid queries and clarification to Tender :**

The tenderer should carefully examine and understand the specifications, terms and conditions of the Tender and may seek clarifications, if required. The tenderer in all such cases seek clarification in writing in a word document (.doc) in the same serial order of that of the Tender by mentioning the relevant page number and clause number of the Tender. The soft copy of the pre-bid queries should be sent by E-Mail to psitw.premises@kgbk.in and the pre-bid query should be in the following format.

Sl No	Page No	Tender Clause No	Tender Clause	Query

All communications regarding points requiring clarifications and any doubts shall be given in writing to the **THE GENERAL MANAGER, KARNATAKA GRAMEENA BANK, GENERAL ADMINISTRATION WING, No-32, GANDHINAGARA, HEAD OFFICE, BALLARI - 583103, Phone: 08392-236430/428** or psitw.premises@kgbk.in through mail by the intending tenderers on **29.04.2026 before 12.00 pm**. No oral or individual consultation shall be entertained. No queries will be entertained from the tenderers after the pre-bid meeting.

A pre-bid meeting of the intending tenderer will be held as scheduled below to clarify any point /doubt raised by them in respect of this Tender document:

Date	Time	Venue
29.04.2026	3.30 PM	KARNATAKA GRAMEENA BANK, GENERAL ADMINISTRATION WING, No-32, GANDHINAGARA, HEAD OFFICE, BALLARI - 583103, Phone: 08392-236430/428

No separate communication will be sent for this meeting. If the meeting date is declared as a holiday under NI Act by the Government subsequent to issuance of RFP, the next working day will be deemed to be the pre-bid meeting day. Authorized representatives of interested tenderers shall be present during the scheduled time.

The Bank will consolidate all the queries and discussions during the pre-bid meeting and the consolidated replies for the queries shall be made available in the Bank's website and no individual correspondence shall be made. The replies/clarification of the Bank in response to the queries raised by the bidder/s, and any other clarification / amendments / corrigendum furnished hereof will become part and parcel of the Tender document and it will be binding on the tenderers.

Non-reply to the queries raised by any of the Tenderer shall not be accepted as a valid reason for non-submission of the Tender. In addition, non-reply to any query may not



be deemed the version of the Tenderer as reflected in the query has been accepted by the Bank.

17) Amendment to Tender document :

At any time prior to deadline for submission of Tender, the Bank, for any reason, whether, at its own initiative or in response to a clarification requested by prospective bidder may modify the Tender document by amendment.

Notification of amendments will be made available on the Bank's website (<https://karnatakagb.bank.in/tenders>) and will be binding on all tenderers and no separate communication will be issued in this regard.

In order to allow prospective tenderers reasonable time in which to take the amendment into account in preparing their tender, the Bank, at its discretion, may extend the deadline for a reasonable period as decided by the Bank for the submission of tender.

For & on behalf of the Karnataka Grameena Bank

Date:

**GENERAL MANAGER,
KARNATAKA GRAMEENA BANK,
GENERAL ADMINISTRATION WING,
No-32, GANDHINAGARA, HEAD OFFICE, BALLARI**

GENERAL RULES AND DIRECTIONS TO TENDERERS

1. All work proposed for execution by contract will be notified in a form of Invitation to Tender and signed by the Bank Officer inviting tender.
2. In the event of the tender being submitted by a firm, it must be signed separately by each partner thereof or in the event of the absence of any partner, it must be signed on his behalf by a person holding a power-of-attorney authorizing him to do so, such power of attorney to be produced with the tender, and it must disclose that the firm is duly registered under the Indian Partnership Act 1952 by enclosing a copy of the partnership deed duly certified by one partner as true copy.

Tender by Hindu Joint Family (HUF) firm may be signed by the Kartha or Manager or any other duly authorized representative followed by the name and designation. All documents related to the firm/HUF/Companies/Partnership firms/etc should be submitted invariably.

3. Receipts for payments made on account of a work, when executed by a firm, shall be in the name of the firm by one of the partners, or by some other person having due authority to give effectual receipts for the firm.
4. Any person who submits a tender shall fill up the printed prescribed form viz. Application, Annexures, BOQ-Bill of Quantity etc. with complete details and duly stating what rate he is willing to undertake each item of the work in the BOQ. Modifications to specifications, item description, any clauses, conditions or any provisions whatsoever in the tender documents shall lead to disqualification of the tender.
5. **The rate quoted shall comply to the following :**
 - (a) The rate(s) and/or amount(s) must be quoted in decimal coinage. Amounts must be quoted in full rupees by ignoring fifty paise and less and considering more than fifty paise as rupee one.
 - (b) In case of illiterate contractors the rates or the amounts should be attested by a witness, with a declaration that the contents of the tender documents have been explained to the tenderer.
 - (c) The rate columns should be filled in English figures and English words.

6. All rates shall be quoted only on the tender form. Quoted rates and units different from prescribed in the tender schedule will be liable for rejection. The amount for each item should be worked out and requisite totals given. Special care should be taken to write the rates in figures as well as in words and the amounts in figures only, in such a way that interpolation is not possible. The total amount should be written both in figures and in words.

All corrections such as cuttings, interpolations, omissions and over-writings shall be attested accordingly and should be numbered and total corrections should be written at the end of the bill / schedule of quantities. Use of correcting fluid, anywhere in tender document is not permitted. Such tender is liable for rejection.

The bidder shall also ensure that the sum of total of each item is tallying with the grand total. Any difference in the total will not be considered. Also the final quote to be considered are excluding GST.

7. In the event of a tender being disqualified and rejected, the earnest money forwarded with such unaccepted tender shall thereupon be returned to the contractor remitting the same, without any interest.

8. The Officer inviting tenders shall have the right of rejecting all or any of the tenders and will not be bound to accept the lowest or any one tender.
9. The Tenderer shall take all necessary precautions to ensure that all confidential information which the Tenderer obtains in the course of participating in this Tender or at any time thereafter is not disclosed or used other than for the purpose of project execution / scope of work / deliverables. Tenderer shall suitably defend, indemnify Bank for any loss / damage suffered by Bank on account of and to the extent of any disclosure of such confidential information. Confidential information for this purpose refers to such information pertaining to Bank provided to Tenderer which is marked as confidential and which is not available in the Public Domain.
10. In the case of item rate tenders, only rates quoted shall be considered. Any tender containing percentage below / above the rates quoted is liable to be rejected. Rates quoted by the contractor in item rate tender in figures and words shall be accurately filled in so that there is no discrepancy in the rates written in figures and words. However, if a discrepancy is found, the rates which correspond with the amount worked out by the contractor shall unless otherwise proved be taken as correct. In case the same item appears more than once in the schedule of work under the same sub head or among the different sub heads of works, the lowest rate quoted for that item shall be taken for other items also and tender will be evaluated accordingly.
11. The contractor whose tender is accepted shall be required to furnish by way of **Initial security** a sum which shall be equal to 2% (two percent) of the accepted value of the tender including the Earnest Money Deposit, within 7 (Seven) days of the date of issue of the letter of acceptance of his tender, Demand Draft payable to the Karnataka Grameena Bank or by way of **Bank Guarantee from any other Scheduled Bank other than Karnataka Grameena Bank in the prescribed format** for the duration of the contract period and defect liability period. A further sum of 8% (eight percent) of the Gross value of each interim/final bill shall be deducted as retention money to make up, together with the Initial Security Deposit totalling to 10%.

In case the successful tenderer fails to remit the Initial security deposit within the above stipulated time, the Earnest money deposit shall be forfeited and the work may be assigned to other bidders as per the decision of the bank.
12. In the case of any tender where unit rate of any item/items appears unrealistic, such tender will be considered as unbalanced and in case the tenderer is unable to provide satisfactory explanation such a tender is liable to be disqualified and rejected and / or the tenderer is liable for **additional security deposit** as demanded by the Employer in the form of Demand Draft or Bank guarantee from scheduled commercial Bank other than Karnataka Grameena Bank valid for contract period / smaller period (as decided by the Bank) in the **format** prescribed by the Bank.
13. On acceptance of the tender, the name of the accredited representative(s) of the contractor who would be responsible for taking instructions from the Employer and / or Engineer-in-charge shall be communicated in writing to Employer.
14. The rates quoted shall be all inclusive rates for the item of work described, including materials, labour, tools and plant, lead, lift carriage and transport supervision, Royalties, duties, levies, cess, entry tax, Octroi, profession tax, purchase tax, turnover tax, or any other tax on material in respect of this contract, overheads and profits, mobilizing, demolishing and other charges whatsoever including any special difficulties any restrictions for transport etc., complete for proper execution of the work as per

drawings and specifications and no claim whatsoever for any extra payment shall be maintainable.

GST or any other Tax, any royalties, duties, levies, cess, Entry Tax, octroi, Profession Tax, Turnover Tax or any other Tax on material in respect of this contract shall be payable by the tenderer and the Bank will not entertain any claim whatsoever in respect of the same and nothing extra shall be paid / reimbursed for the same subsequently. The rates quoted shall include all the above. GST on works contract on finished works wherever applicable shall be paid by Bank as per extant rules. All charges payable to local bodies for any service connections for construction purposes, land tax, etc., shall also be paid by the contractor and nothing extra shall be paid/reimbursed for the same.

15. The contractor shall give a list of the Bank employees related to him with their places of posting and designations in prescribed Format.
16. The tender for the work shall not be witnessed by a contractor or contractors who himself/themselves has/have tendered or who may and has/have tendered for the same work. Failure to observe this condition would render tenders of the contractors tendering, as well as witnessing the tender, liable to summary rejection.
17. Errors and omissions due to clerical, typographical or printing etc., if any, will have to be got clarified and corrected before quoting the rates. The interpretation given by the appropriate tender accepting authority of the Bank shall be final and binding.
18. Procurement of all materials, other than specifically stipulated to be issued by the Bank, if any, shall be at the cost and the responsibility of the contractor.
19. The Contractor should co-ordinate with the Elevator Supplier/Manufacturer to support the installation of the Elevator in the premises. All civil works and finishing touch related to the installation of elevator should be carried by the contractor only.

20. PROVISIONS FOR MICRO & SMALL ENTERPRISES (MSES):-

As per Government of India's Public Procurement Policy act 2012, certain benefits will be given for MSE Units. The details are as under.

The Public Procurement Policy shall apply to MSEs registered with District Industries Centres or Khadi Village Industries Commission or Khadi & Village Industries Board or Coir Board or National Small Industries Corporation or Directorate of Handicrafts & Handloom or any other body specified by Ministry of Micro, Small & Medium Enterprises.

MSEs are exempted from paying Tender/RFP fee/cost, EMDs. For getting the benefits in case of MSE firms, shall submit relevant documents such as valid MSE registration Certificates as per policy.

22. Tenderer shall fill in all the blanks and put their signature and seal on each page of the tender documents. The successful Tenderer will have to enter into an agreement with each component of the Tender document with the Bank.
23. The tender drawings under this NIT are only indicative to broadly understand the scope of the works. The contractor shall carry out the works according to the workings drawings/ construction drawings issued by the Engineer in charge during the course of work from time to time. Tenderer/ Contractor is not eligible for any claim on account of any differences between the tender drawings and working drawings.



SPECIAL CONDITIONS OF THE CONTRACT:

1. The scope of proposed works involves undertaking the civil & Plumbing works based upon the parameters furnished for carrying out the civil, Plumbing and Repair/Renovation works with its allied works etc. complete as per specification described in the Schedule/Bill of Quantities.
2. All the works as per the schedule/Bill of quantities (SOQ/BOQ) are to be undertaken at Karnataka Grameen Bank, Head office-Annex, Dharwad.
3. The project involves execution of other related works like Electrical, Lift/Elevator Installation etc.. Hence the responsibility of proper co-ordination with other agencies who are assigned with above mentioned works, rests with the successful tenderer of this subject work / contract.
4. **QUOTED RATES:**
 - (i) Contractor should note that, **the tender is strictly on item rate basis** and tenderers attention is drawn to the fact that rates for each and every item should be correct, workable and self-supporting. The quantities in the Schedule of Quantities approximately indicate the total extent of work but few items may vary beyond 25% quantity and few items may not be even operated.
 - (ii) The quoted rates shall be inclusive of all type of taxes (income tax, work contract tax, Goods & Sales tax), octroi, excise duty, service charges, loading, unloading, transportation, lead & lift charges and all charges incidental to complete the assigned works in all respects as per tender specifications and terms & conditions.
 - (iii) If called upon by the Bank, detailed analysis of any or of all the items shall be submitted by the Contractor. In case there are variations in the rates for items of same/ similar specifications, in such cases, the lowest rate quoted shall be considered unless Bank finds that there is justification for such inconsistent rates and this shall be the basis for any assessing any other non-tendered items also.
5. **WORKS AND SITE TO BE KEPT AND DELIVERED UP CLEAN:** All dirt, waste and other rubbish as it accumulates from time to time during the progress of the work and at completion, including that of sub-contractors and special tradesmen to be cleared and carted away and all materials rejected by the Bank's representative to be removed and disposed off to approved dumping ground / area . Internal cleaning shall be done on daily basis & clearing of the debris shall be as & when the accumulated quantity comes to one tractor load. Contractor's quoted rates shall be inclusive of the cost of this cleaning / clearing.
6. **Supply of electricity, water, use of lift, storage space etc:** The successful tenderer will be allowed to make judicious use of the existing facilities of electrical power, water supply, for carrying out the tender works at one point, However Permission/Separate supply from Electricity Board etc. will have to be taken by the contractor at his own cost. Within the work place, the contractor may make their own arrangement for safe keeping / storage of materials. Bank shall not provide any separate storage place for keeping the materials or for the site office and contractor shall be fully responsible for the safety of the materials, their labours.



GENERAL CONDITIONS OF THE CONTRACT.

1. INTERPRETATION

In construing these conditions, the specifications, the schedule of quantities, tender and Agreement, the following words shall have the meaning herein assigned to them except where the subject or context otherwise requires.

Employer or Bank: The term "Employer" or "Bank" shall denote KARNATAKA GRAMEENA BANK with their Head Office at BALLARI represented by General Manager, General Administration Wing, Karnataka Grameena Bank, Head Office :: Ballari and any of its employees or representative authorized on their behalf.

Architects: The term "Architects" shall mean Architect appointed by the Bank or such other person/s the Employer shall nominate for the purpose, details of the same shall be shared with the successful L1 contractor of the Tender.

Site Engineer: The term "Site Engineer" shall mean authorized Engineer appointed by Architect or Bank for supervision of works at site as per tender terms.

Contractors: The term "Contractor," "Bidder" or "Tenderer" shall mean _____ (Name and address of Contractor) and his/their heirs, legal representatives, assigns and successors.

Site: The "site" shall mean the Ground, 1st and 2nd Floor of Standalone Building at Karnataka Grameena Bank Head Office-Annexe, Dharwad, where the renovation works are to be carried out..

Drawings: "Drawings" means the drawings referred to in the Specification and any modification of such drawings approved in writing by the Architect/ Bank and such other drawings as may from time to time be furnished or approved in writing by the Architect/ Bank.

Work / Works shall mean the work or works to be executed or done under this contract and shall include materials, apparatus, equipment, plant, fittings and other things for incorporation in the works.

Contract means the contract effected by the contractor's Tender and the Employer's acceptance thereof comprising (in addition to the Tender and Acceptance) the priced Schedule of Quantities and Schedules, Schedules of particulars (if any), Specifications and Drawings, these General Conditions of Contract, Special Conditions contained in, Appendices, Annexure or attached to any of the forgoing documents, any alterations agreed in writing between the parties before the formal acceptance of the Tender, all these documents taken together, shall be deemed to form one contract and shall be complementary to one another.

"Technical Specification" means the specification annexed to or issued with this tender or detailed in the schedule of quantities.

"Approved" means approved in writing including subsequent written confirmation of previous verbal approval and "approval" means approval in writing including as aforesaid.

'Market rate" means the rate as prevailing in the market and recommended by the Architect and as approved by the Employer on the basis of cost of materials, labour, plant etc inclusive of any tax, duty, octroi etc. at the time of execution of work.

"The Schedule of Quantities" or "Priced Schedule of Quantities" shall mean the schedule (or bill) of quantities with specifications as specified and forming part of this contract.

"Act of Insolvency" shall mean any act such as defined by the Presidency Towns Insolvency Act or in Provincial Insolvency Act or any amending statutes.

2. SCOPE OF WORKS :

The work consists of **Civil Works, Plumbing And Repair/Renovation Works at KGB, Head Office-Annex, Dharwad** in accordance with the "Schedule of Quantities". Employer/Architects may in their absolute discretion issue further and/or written instruction, details, directions & explanations, which are, hereafter collectively referred to as "The Employer's instructions" in regard to:

- a) The variation or modification of the design quality or quantity of works or the addition or omission or substitution of any work.
- b) Any discrepancy in the drawings or between the schedule of quantities and/or drawings and/or specification.
- c) The removal from the site of any defective material brought thereon by the contractor and the substitution of any other material thereof.
- d) The demolition removal and/or re-execution of any work executed by the contractor/s.
- e) The dismissal from the work of any persons employed there upon.
- f) The opening up for inspection of any work covered up.
- g) The rectification and making good of any defects under clauses hereinafter mentioned and those arising during the defect liability period.

The work is to be carried out in accordance with drawings, specifications, the schedule of quantities and any further drawings, which may be given by the Architect/ Bank during the execution of the work.

In case any detailed Working/Fabrication/Shop Drawings are necessary, contractor shall prepare such detailed drawings and/or dimensioned sketches thereof and get approved by the Bank / Architect prior to taking up such work.

The contractor shall ask in writing for all clarifications on matters occurring anywhere in drawings for additional instructions at least 10 days ahead from the time when it is required for implementations so that the Employer may be able to give decision thereon.

No works, for which rates are not specifically mentioned in the priced schedule of quantities, shall be taken up without written permission of the Employer/Architects. Rates of items not mentioned in the priced schedule of quantities shall be fixed by the employer in consultation with the Architects as provided in Clause "variation".

Regarding all factory made products for which **ISI marked products** are available, only products bearing ISI marking shall be used in the work.

The whole work including all extra and additional items if any is to be completed within the period of completion as stated in Notice Inviting the Tender and the Contractor will be required, if necessary to work overtime to fulfill the Banks/Architect's instruction to complete the work by the stipulated date. No extra payment will be allowed on the quoted rates for such overtime work.

3. TENDER

The tenderers should note that the tender is strictly on the item rate basis and their attention is drawn to the fact that the rates for each and every item should be correct, workable and self-supporting.

The works will be paid for as "measured work" on the basis of actual work done on item rate basis and not as "lump sum" contract as per the rate quoted in the Schedule/Bill of quantities.

All items of work described in the schedule of quantities are to be deemed and paid as complete works in all respects and details including preparatory and finishing works involved, directly, related to and reasonably detectable from the drawings, specifications and schedule of quantities and no further extra charges will be allowed in this connection.

In the case of items of lump-sum charges in the tender in respect of any item of works, the payment of such items of work will be made for the actual work done on the basis of lump-sum rates as will be assessed to be payable by the Employer/Architects.

4. AGREEMENT , INDEMNITY BOND

The successful contractor shall sign a Contract Agreement as per format enclosed as **Appendix-3** and shall pay for all stamps paper charges and legal expenses, incidental thereto. The contractor shall submit Indemnity Bond as per format enclosed as **Appendix-4**

The contract agreement and Indemnity bond shall be executed within **7 days** from the from the date of receipt of letter of acceptance of tender, failing which the Employer at his discretion, without prejudice to any other rights/remedies available under the terms of this Contract may revoke the letter of acceptance and forfeit the Earnest money deposit furnished along with the tender.

5. PERMITS AND LICENCES

Permits and Licenses for release of materials, which are under Government control, shall be arranged by the contractor. The Employer may render necessary assistance, sign any forms or applications that may be necessary but shall not be responsible for actual procurement or for any delay in procurement.

It may be clearly understood that no compensation or additional charges can be claimed by the contractor for non-receipt of any controlled materials in due time on this account or according to his own requirements.

The Employer/Architects shall be indemnified against all Government or legal actions for theft or misuse of controlled materials in the custody of the contractor.

All the licenses required to carry work inside premises, utilization of electricity, to dispose waste etc. should be obtained by the contractor at his own cost and he shall be liable for any such violations and hence penalties levied from government authorities shall be payable from the contractor only.

6. GOVERNMENT AND LOCAL RULES

The contractor shall confirm to the provisions of all local laws and Acts relating to the work and to the Regulations etc., of the Government and Local Authorities. The cost, if any, shall be deemed to have been included in quoted rates, taking into account all liabilities for licenses, fees. The tenderer shall indemnify the Employer against any such liabilities in compliance of the local acts, rules.

7. QUOTED RATES

The rates shall be as per the Schedule of Quantities and include the following:

- (i) The rates quoted by the contractor shall be held to include for providing all materials, testing of materials, labour and fixing all scaffolding, conveyance and delivery, unloading, carrying in storing, hoisting, all labour, setting, fitting and fixing in position making, cutting, wastages, return of packing and all materials and labour and cleaning of work place, everything else necessary for the proper completion of each item of work including overheads and profits.
- (ii) The rates must include in their tender rates quoted for all duties royalties, cess, sales tax, VAT, service tax or any other taxes or local charges if applicable. Any variations in the above shall not be paid. No extra claim on this account will in any case be entertained.
- (iii) The rates quoted by the contractor should cover for work at all heights and levels for all items of work under this contract. Lifting of materials will not form any criteria for claiming extra payment.

FUNCTIONING BRANCH/ OFFICE - Timings of work - Cleaning of site on daily basis

Wherever the works are carried out measures should be taken to avoid dust towards adjacent buildings and to plan accordingly to ensure that no heavy sounding work/transportation of material and dust disposal will be planned in the site during office hours.

The works, all cuttings, waste materials, rejected materials and other rubbish as it accumulates shall be cleaned from time to time during the progress of the work as per the local municipal guidelines and at completion of each days work and to be cleared and carted away from the branch premises / site. No such waste of any type should be kept in and around the premises (not just the site) and shall be disposed outside the compound as per the Municipal guidelines.

Contractor's quoted rates shall allow for the above factors also.

8. QUANTITY OF WORK TO BE EXECUTED

The quantities shown in the schedule of quantities are only approximate and are intended to cover the entire work but the Employer reserves the right to execute only a part or the whole or any excess thereof without assigning any reason therefore. In case of increase it shall be as per the variation clause.

9. OTHER PERSONS ENGAGED BY THE EMPLOYER

The Employer reserves the right to execute any part of the work included in this contract or any work, which is not included in this contract by other Agency or persons, and contractor shall allow all reasonable facilities and use of his scaffolding for the execution of such work. The main contractor shall extend all cooperation in this regard.

10. EARNEST MONEY, SECURITY DEPOSIT & RETENTION MONEY

The tenderer will have to deposit the amount specified in the NIT at the time of submission

of tender as Earnest Money deposit. No interest shall be paid on the Earnest Money deposit.

The successful tenderer to whom the contract is awarded will have to deposit as Initial security deposit a further sum to make up 2% of the value of the accepted tender including the Earnest Money. The initial Security Deposit will have to be made within **7 days** from the date of receipt of letter of acceptance of tender, failing which the Employer at his discretion, without prejudice to any other rights/remedies available under the terms of this Contract may revoke the letter of acceptance and forfeit the Earnest money deposit furnished along with the tender. No interest shall be paid on the Initial security deposit.

Apart from the initial security deposit made as above, retention money shall be deducted from progressive running bills @ 8% of the gross value of each running bill till the **total security deposit** ,(i.e., the initial Security Deposit plus the retention money) equals the 10% of the total billed amount.

The total security deposit amount will be refunded to the contractor, after deducting any sum due from the contractor on any account under this contract, 14 (fourteen) days after the end of **defects liability period** provided he has satisfactorily rectified all the defects in accordance with the conditions of the contract. No interest is allowed on retention money & total security deposit.

11. CONTRACTOR TO PROVIDE EVERYTHING NECESSARY

The contractor shall provide everything necessary for the proper execution of the work according to the intent and meaning of the drawings, schedule of quantities and specifications taken together whether the same may or may not be particularly shown or described therein provided that the same can reasonably be inferred there from and if the contractor finds any discrepancies therein he shall immediately and in writing, refer the same to the Employer/ Architects whose decision shall be final and binding.

The rates quoted against individual items will be inclusive of everything necessary to complete the said items of work within the contemplation of the contract, and beyond the unit price no extra payment will be allowed for incidental or contingent work, labour and/or materials inclusive of all taxes and duties whatsoever except for specific items, if any, stipulated in the tender documents.

The contractor shall supply, fix and maintain at his own cost, for the execution of any work, all tools, tackle, machineries and equipments and all the necessary centering, scaffolding, staging, planking, timbering, watching and lighting by night as well as by day required not only for the proper execution and protection of the said work **but also for the protection of the public and safety of any adjacent** walls, houses, building, all other erections, matters and things and the contractor shall take down and remove any or all such centering, scaffolding, planking, timbering, strutting, shorting etc., as occasion shall be required or when ordered so to do, and shall fully reinstate and make good all matters and things disturbed during the execution of works to the satisfaction of the Employer/ Architects.

The contractor shall at all times give access to **workers employed by the Employer** or any men employed on the premises and to provide such parties with proper sufficient and if required, special scaffolding, hoists and ladders etc..in any work, where directed by the employer as may be required to enable such workmen to lay or fix pipes, electrical wiring, special fittings etc. The quoted rates of the tenderers shall accordingly include all these above-mentioned contingent works.

12. TIME OF COMPLETION, EXTENSION OF TIME & PROGRESS CHART:

Time of completion: The entire work is to be completed in all respects within the stipulated period stated in Appendix - 1.

The order to commence the works shall be given by the Bank only after depositing the Initial security deposit, signing of agreement & submission of Indemnity bond.

Time is the essence of the contract and shall be strictly observed by the contractor.

Extension of Time: If in the opinion of the Employer/ Bank the works were delayed for reasons beyond control of the contractor, the Bank may grant a fair and reasonable extension of time for completion of the contract works.

Request for extension of time, to be eligible for consideration, shall be made by the Contractor in writing within fourteen days of the happening of the event causing delay to the Architect/ Bank. The Contractor shall also, if practicable, indicate in such a request the total period for which extension is desired, overlapping period, if any, with earlier events causing delays, net extension required.

In such case, the Employer may give a fair and reasonable extension of time for completion of work. Such extension shall be communicated to the contractor by the Employer in writing, within **7 days** of the date of such request.

While granting extension, the Employer shall notify the contractor the period of time which will not qualify for levy of liquidated damages.

For the period in excess of original stipulated time period and authorized extension of time (i.e. period not qualifying for levy of liquidated damages), granted by the Employer, the provision of liquidated damages as stated under **Clause 13** hereof will become applicable.

However, the contract shall remain in force even for the period beyond the due date of completion irrespective whether the extension is granted or not.

Progress of work: The contractor shall maintain proportionate progress on the basis of a Programme Chart submitted by the contractor immediately before commencement of work and agreed to by the Employer/ Architects. Contractor should also include planning for procurement of scarce material well in advance and reflect the same in the programme chart so that there is no delay in completion of the project.

13. LIQUIDATED DAMAGES

Time is the essence of the contract. The completion of the **works** is essential to comply with various requirements of the bank. Thus the contractor shall be aware and take note that non-completion of the works will affect the Banks committed programs and thus the loss by way delayed completion of related works etc, are invaluable and cannot be easily assessed. Therefore, it is part of the agreed terms that in the event of any delay in completion of the work, the Bank is liable to charge the Contractor without the necessity of providing for any details of such losses suffered by the Bank.

Thus if the Contractor fails to complete the works within the time for completion stated in the Notice Inviting the Tender or within any extended time under **Clause 12** hereof, the

Contractor shall pay the Employer the sum at the rate of **1%(one per cent) of the Contract Value per week of delay subject to a limit of 10%(ten per cent) of the Contract Value as "Liquidated damages"** for the period during which the said works shall so remain incomplete or the Employer may deduct aforesaid sum towards such damages from any monies due to the Contractor.

For this purpose the term `Contract Value' shall be value at the contract rates of the work as ordered / accepted.

The Employer shall have the right to adjust, / set-off against any sum payable to the contractor under this or any other contract with the Employer anywhere in India/outside India.

14. PROTECTION TO WORKS, STORAGE

Protective Measures: The contractor shall make suitable arrangements for watching and protecting the works and surrounding property by day, by night, on Sundays and other holidays, on round the clock basis and no extra will be paid by Bank for such services.

Contractor shall indemnify the Employer against any possible damage to the building, roads or members of the public in course of execution of the work.

Should the work be suspended by reason of rain, strike, lockouts or any other cause, the contractor shall take all precautions necessary for the protection of work and at his own expenses shall make good any damage arising from any of these causes.

Storage of materials: The contractor shall provide adequate protection of the materials, work etc., and also other work that may be executed on the site.

All offensive, inflammable materials shall not be stored in the premises.

15. NOTICE AND PATENTS OF APPROPRIATE AUTHORITY AND OWNERS

The contractor shall conform to the provisions of any Acts of the Legislature relating to the work, and to the Regulations and Bye-laws of any authorities, and /or any water, lighting and other companies, and/or authorities with whose systems the structures were proposed to have connection and shall before making any variations from the drawings or specification that may be associated to so conform, give the Employer/Architects written notices specifying the variations proposed to be made and the reasons for making them and apply for instruction thereon. The Employer/Architects on receipt of such intimation shall give a decision within a reasonable time.

The contractor/s shall arrange to give all notices required for by the said Acts, Regulations or Bye-laws to be given to any authority, and to pay to such authority or to any public officer all fees that may be properly chargeable in respect of the work and lodge the receipts with the Employer.

The contractor shall indemnify the Employer against all claims in respect of patent rights, royalties, damages to buildings, roads or members of public in course of execution of work and shall defend all actions arising from such claims and shall keep the Employer saved harmless and indemnified in all respects from such actions, costs and expenses.

16. SETTING OUT WORKS

The contractor shall set out the works and shall be responsible for the true and perfect setting out of the work and for the correctness of the positions, levels, dimensions and alignment of all parts thereof. If at any time, any error shall appear during the progress of any part of the work, the contractor shall at his own expenses rectify such error, if called upon to the satisfaction of the Employer. The contractor shall further set out the works to the alternative positions at the site until one is finally approved and the rates quoted in his tender should include for this and no extra on this account will be entertained.

17. MATERIALS, WORKMANSHIP, SAMPLES OF MATERIALS

All the materials (except where otherwise described) stores and equipment required for the full performance of the work under the contract must be provided through normal channels and must include charge for import duties, sales tax, octroi, VAT, service tax and other charges and must be the best of their kind available and the contractor/s must be entirely responsible for the proper and efficient carrying out of the work.

The work must be done in the best workman like manner.

Samples of all materials to be used must be submitted to the Employer/Architects when so directed by the Engineer/ Architects and written approval from Employer/Architects must be obtained prior to placement of order for the material.

Before ordering any material, the Contractor shall get samples of the materials approved from the Bank/ Architect well in time. The samples of materials shall be got tested from approved laboratories at the contractor's cost before approval if ordered by the Bank/ Architect. No claim will be allowed for delay to the progress of work caused by tests. If called upon by the Bank, the contractor shall produce proof for having arranged for the supply of materials well in time.

18. REMOVAL OF IMPROPER WORK, RECTIFICATION, REJECTED MATERIALS

The Employer shall during the progress of the work have power to order for removal of work within such reasonable time or times as may be specified in the order of any materials which in the opinion of the Employer/Architects are not in accordance with specifications or drawings or instructions.

All materials / or workmanship which in the opinion of the Bank are / is defective / not conforming to specifications / drawings or un-suitable, shall be removed immediately from the site and shall be substituted/ reworked with proper material and / or workmanship forth with as per drawings, specifications at the cost of the contractors .

In case the contractor refuses to comply with the orders of the Employer/ Architect, then the Employer shall have the power to employ and pay other agencies to carry out the work and all expenses consequent thereon or incidental thereto as certified by the Employer/ Architects shall be borne by the contractor or may be deducted from any money due to or that may become due to the contractor under this contract or any other contract. No certificate, which may be given by the Architects/ employer, shall relieve the contractor from his liability in respect of unsound work or bad materials.

19 ACCESS

Any authorized representative of the Employer/ architect shall at all reasonable times have free access to the works and/or to the workshop, factories or other places where materials are being prepared or constructed for the work and also to any place where the materials

are lying or from where they are being obtained, and the contractor shall give every facility to the Employer or their representatives necessary for inspection and examination and test of the materials and workmanship. Except the representatives of the Employer no person shall be allowed at any time without the written permission of the Employer.

20. SITE ENGINEER

The term 'Site Engineer' shall mean the person appointed and paid by the Employer/Architect to superintend the work. The contractor shall afford the Site Engineer every facility and assistance for examining the works and materials and for checking and measuring work and materials as and when the Bank/Engineer require them to.

The work will from time to time be examined by the Architects, Engineer from the Premises Department of the Employer and the Site Engineer. But such examination shall not in any way exonerate the contractor from the obligation to remedy any defects, which may be found to exist at any stage of the work or after the same is complete. Subject to the limitations of this clause the contractor shall take instructions only from the Architects/Employer.

21. CONTRACTOR'S EMPLOYEES

The contractor shall employ technically qualified staff and competent supervisors for the work who shall be available (by turn) throughout the working hours to receive and comply with instructions of the Employer/Architects. The contractor shall employ in connection with the work, persons having the appropriate skill or ability to perform their job efficiently.

No labourer below the age of Eighteen years shall be employed on the work.

Any labourer supplied by the contractor to be engaged on the work on day-work basis either wholly or partly under the direct order or control of the Employer or his representative shall be deemed to be a person employed by the contractor.

The contractor shall comply with the provisions of all labour legislation including the requirements of

- a) The Payment of Wages Act
- b) Minimum wages Act
- c) Employer's Liability Act
- d) Workmen's Compensation Act
- e) Contract Labour (Regulation & Abolition) Act, 1970 and Central Rules 1971
- f) Apprentices Act 1981
- g) Any other Act or enactment relating thereto and rules framed there under from time to time.
- h) Indian Electricity Act (IE Act) and follow the rules.

The contractor shall keep the Employer saved harmless and indemnified against claims if any of the workmen and all costs and expenses as may be incurred by the Employer in connection with any claim that may be made by any workmen.

The contractor shall comply at his own cost with the order of requirement of any Health Officer of the State or any local authority or of the Employer regarding the maintenance of proper environmental sanitation of the area where the contractor's labourers are housed or accommodated, for the prevention of small pox, cholera, plague, typhoid, malaria and other contagious diseases. The contractor shall provide, maintain and keep in good sanitary accommodation and provide facilities for pure drinking water at all times of the use of men

engaged on the works and shall remove and clear away the same on completion of the works. Adequate precautions shall be taken by the contractor to prevent nuisance of any kind on the works or the lands adjoining the same.

The contractor shall arrange to provide first aid treatment to the labourers engaged on the works. He shall within 24 hours of the occurrence of any accident at or about the site or in connection with execution of the works, report such accident to the Employer and also to the competent authority where such report is required by law.

The contractor shall pay rates of Wages and observe hours of work and conditions or employment according to existing rules under Minimum Wages Act. Further, it shall be contractor's responsibility to ensure that he pays his workmen wages which are not lower than the minimum prescribed by the Union Government and State Government in which area this contract is being operated.

22. DISMISSAL OF WORKMAN

The contractor shall on the request of the Employer immediately dismiss from works any person employed thereon by him, who may in the opinion of the Employer be unsuitable or incompetent or who may misconduct himself. Such discharges shall not be the basis of any claim for compensation or damages against the employer or any of their officer or employee.

23. DAMAGE TO PERSONS AND PROPERTY INSURANCE ETC.

The contractor shall be responsible for all injury to the work or workmen, persons, animals or things and for all damages to the structural and/or decorative part of property which may arise from the operations or neglect of himself or of any sub-contractor or of any of his or a sub-contractor's employees, whether such injury or damage arise from carelessness, accident or any other cause whatsoever in any way connected with the carrying out of this contract. The clause shall be held to include inter-alia, any damage to buildings whether immediately adjacent or otherwise, and any damage to roads, streets, foot paths or ways as well as damages caused to the buildings and the works forming the subject of this contract by rain, wind or other inclemency of the weather. The contractor shall indemnify the Employer and hold harmless in respect of all and any expenses arising from any such injury or damages to persons or property as aforesaid and also in respect of any claim made in respect of injury or damages under any acts of compensation or damage consequent upon such claim. **The contractor shall submit an indemnity bond in Bank's approved proforma (enclosed under Appendix-4) in a stamp paper. Indemnify the Bank / Architect from any damages, prosecution, other legal suits and claims arising out of any mishaps occurring at the site due to faulty work, faulty construction and for violating rules and regulations for which the contractor shall be solely responsible.**

The contractor shall reinstate all damage of every sort mentioned in this clause, so as to deliver the whole of the contract works complete and perfect in every respect and so as to make good or otherwise satisfy all claims for damages to the property or third parties.

The contractor shall also be responsible for anything, which may be excluded from damage to any property or injury to workers/professionals arising out of incidents, negligence or defective carrying out of this contract. All insurances related to such unforeseen circumstances shall be insured by the contractor at his own cost.

The Employer shall be at liberty and is hereby empowered to deduct the amount of any damages, compensations, costs, charges and expenses arising or accruing from or in respect of any such claim or damages from any sums due or to become due to the contractor.

25 ACCOUNTS RECEIPTS & VOUCHERS

The contractor shall, upon the request of the Employer furnish them with all the invoices, accounts, receipts and other vouchers that they may require in connection with the works under this contract, if the contractor shall use materials less than what he is required under the contract, the value of the difference in the quantity of the materials he was required to use and that he actually used shall be deducted from his dues. The decision of the Employer shall be final and binding on the contractor as to the amount of materials the contractor is required to use for any work under this contract.

26 . MEASUREMENTS

All measurements shall be carried out as per relevant IS code unless otherwise stated elsewhere in this document. Before taking any measurement of any work the Site Engineer/ Architect/ employer or a subordinate deputed by him shall give reasonable notice to the contractor. If the contractor fails to attend at the measurements after such notice or fails to counter sign or to record the difference within a week from the date of measurement in the manner required by the Site Engineer then in any such event the measurements taken by the Site Engineer or by the subordinate deputed by him as the case may be is final and binding on the contractor and the contractor shall have no right to dispute the same.

27. CONCEALED WORK

The contractor shall give due notice to the Employer/Architects whenever any work is to be concealed or otherwise becoming inaccessible later on, in order that the work may be inspected and correct dimensions taken before such burial, in default whereof the same shall, at the opinion of the Employer/Architect be either opened up for measurement at the contractor's expense or no payment may be made for such materials. Should any dispute or differences arise after the execution of any work as to measurements etc., or other matters which cannot be conveniently tested or checked, the notes of the Employer/Architects shall be accepted as correct and binding on the contractor.

28. INITIAL & INTERIM PAYMENTS

Initial Mobilization Advance: No mobilization advance will be considered by Bank.

Running Bill payments: All bills shall be prepared by the contractor in the form prescribed by the Employer/ Architects. Normally one interim bill shall be prepared each month subject to minimum value for interim certificate as stated in the **Appendix-1**. The bills in proper forms must be duly accompanied by detailed measurements & test certificate in support of the quantities of work done and must show deductions for all previous payments, retention money, etc.

The Architects shall issue a certificate after due scrutiny of the contractor's bill stating the value of the work executed , amount due to the contractor from the Employer and the contractor shall be entitled to payment thereof, within the period of honoring certificate stated in the **Appendix-1** subject to its correctness and verification by Employer & Bank engineer's/Architect's certification.

The amount stated in an interim certificate shall be the value of work properly executed and material advance upto 75% of invoiced value of materials brought to site for permanent incorporation into the work after preparation of the previous bill less the amount to be retained by the Employer as **retention money vide clause 10** of these conditions. Advance paid for materials already incorporated in the work shall be recovered.

The material advance shall be admissible only on materials, which in the opinion of the Architect/ employer are imperishable in nature, are genuinely required for use in the work in the near future, are of the required quality and are adequately protected against damage, theft, loss etc.

If the Employer has supplied any materials or goods to the contractor, the cost of any such materials or goods will be progressively deducted from the amount due to contractor in accordance with the quantities consumed in the work.

All the interim payments shall be regarded as payments by way of advance against the final payment only and not as payments for work actually done and completed, and shall not preclude the requiring of bad, unsound, and imperfect or unskilled work to be removed and taken away and reconstructed, or re-erected or be considered as an admission of the due performance of the contract, or any part thereof in any respect or the accruing of any claim, nor shall it conclude, determine or affect in anyway the power of the Employer under these conditions or any of them as to the final settlement and adjustment of the accounts or otherwise or in any other way vary or affect the contract.

29. FINAL PAYMENT

The final bill shall be submitted by the contractor to the Architect within one month of the date of completion of the work certified by the Architect and payment shall be made within **one month** for such of those items and quantities that in the opinion of the Employer are undisputed.

Payments of final bill shall be made after deduction of Retention Money as specified in **clause 10** of these conditions, which sum shall be refunded as stipulated in **Clause 10**. The acceptance of payment of the final bill by the contractor would indicate that he will have no further claim in respect of the work executed.

30. VARIATION / DEVIATION

The Employer shall have powers to order additional /non-tendered items or to modify the tendered items, to vary the quantities of tendered items and not to execute certain items. All such orders shall be in writing.

The rate or price of all such additional items/non-tendered/modified items will be worked out on the basis of rates quoted for similar items in the contract wherever existing or on engineering rate analysis based on prevalent fair price of labour, material and other components as required. The tender rates shall hold good for any increase or decrease in the tendered quantities up-to variation of 25%.

31. SUBSTITUTION

Should the contractor desire to substitute any materials and workmanship, he/they must obtain the approval of the Employer/Architects in writing for any such substitution well in advance. Materials designated in the Schedule of Quantities and specification indefinitely by such term as "Equal", "Equivalent" or "Other approved" etc. specific approval of the Employer/Architects has to be obtained in writing.

32. COMPLETION OF WORK

On completion of the work the contractor shall clean all windows, doors, fittings, fixtures, furnitures etc of all paint/polish/distemper splashes/dirt/dust / adhesives etc, if necessary all hardware, clean inside and outside, all floor, stair-cases, and every part of the building and the surroundings.

On receipt of such written intimation from the contractor on completion of the work, the Architect/ Employer shall arrange to inspect the work and certify completion if the work has been completed satisfactorily. If not, the Architect/ Employer shall inform the Contractor the deficiencies/defects in the work and the contractor shall attend to them properly and again intimate the Employer/Architect for further inspection.

The work shall not be considered as complete until the Employer/Architects have certified in writing that it has been completed satisfactorily without any apparent defects and the Defects Liability Period shall commence from the date of such certificate

No such certificates shall be issued until the contractor clears away and removes from the site all constructional plant, surplus materials, rubbish temporary works of every kind and leaves the whole of the site and the works clean and in a workman like condition to the satisfaction of the Employer/Architects.

33. DEFECTS AFTER COMPLETION

The contractor shall make good at his own cost and to the satisfaction of the Employer all defects which may appear during the defect liability period of **one year from the date of completion of the works.**

In default the Employer may employ and pay other persons to amend and make good such damages, losses and expenses consequent thereon or incidental thereto shall be made good and borne by the contractor and such damages, loss and expenses shall be recoverable from him by the Employer or may be deducted by the employer, in lieu of such amending and making good by the contractor a sum equivalent to the cost of amending such work and in the event of the amount retained being insufficient, recover that balance from the contractor from the amount retained under **clause No.10** under this contract or any other contract together with any expenses the Employer may have incurred in connection therewith.

34. IDLE LABOUR

Whatever the reasons may be no claim for idle labour, additional establishment cost of hire and labour charges of tools and plants would be entertained under any circumstances.

35. ASSIGNMENT

The whole of the works included in the contract shall be executed by the contractor and the contractor shall not directly or indirectly transfer, assign or sublet the contract or any a part, share or interest therein nor, shall take a new partner, without written consent of the Employer and no subletting shall relieve the contractor from the full and entire responsibility of the contract or from active superintendence of the work during their progress.

36. ESCALATION:

The rate quoted shall be firm throughout the tenure of the contract including extension of time, if any, granted and will not be subject to any fluctuation due to increase in cost of materials, labour, sales tax, VAT, works contract tax, octroi, service tax etc. or any other tax. There shall be NO ESCALATION on the quoted rates.

The basic rates indicated in Schedule of quantities for material is only to facilitate the Bank to select the material.

37. SUSPENSION OF WORK

If the Contractor:

- (i) Having been given by the Bank a notice in writing to rectify, reconstruct or replace any defective work or that the work is being performed in an inefficient or otherwise improper or unprofessional like manner, shall omit to comply with the requirements of such notice for a period of seven days thereafter; or,
- (ii) has without reasonable cause suspended the progress of the work or has failed to proceed with the work so that in the opinion of the bank (which shall be final and binding) that he will be unable to secure completion of the work by the date for completion and continues to do so after a notice in writing of seven days from the bank; or
- (iii) persistently neglects to carry out his obligations under the contract and/or commits default in complying with any of the terms and conditions of the contract and does not remedy it or take effective steps to remedy it within 7 days after a notice in writing is given to him in that behalf by the bank or
- (iv) fails to complete the work within the stipulated date or items of work with individual date of completion, if any, stipulated on or before such date(s) of completion and does not complete them within the period specified in the notice given in writing in that behalf by the Bank ; or
- (v) being a company shall pass a resolution or the court shall make an order that the company shall be wound up or if a receiver or a manager on behalf of a creditor shall be appointed or if circumstances shall arise which entitle the court or the creditor to appoint a receiver or a manager or which entitles the court to make a winding up order; or
- (vi) If the contractor except on account of any legal restraint upon the Employer preventing the continuance of the work or in the opinion of the Employer shall neglect or fail to proceed with due diligence in the performance of his part of the contract or if he shall more than once make default,

In all the above , the Employer shall have the power to give notice in writing to the contractor requiring the work be proceeded within a reasonable manner and with reasonable dispatch, such notice purport to be a notice under this clause.

After such notice shall have been given the contractor shall not be at liberty to remove from the site of the works or from any ground contiguous thereto any plant or materials to subsist from the date of such notice being given until the notice shall have been complied with. If the contractor shall fail for 7 (seven) days after such notice has been given to proceed with the works as therein prescribe, the Employer may proceed as provided in **clause 38** (Termination of Contract by Employer).

38. TERMINATION OF CONTRACT BY EMPLOYER

If the contractor being a company go into liquidation whether voluntary or compulsory or being a firm shall be dissolved or being an individual shall be adjudicated insolvent or shall make an assignment or a composition for the benefit of the greater part, in number of amount of his creditors or shall enter into a Deed or arrangement with his creditors, or if the Official Assignee in insolvency, or the Receiver of the contractor in insolvency, shall repudiate the contract, or if a Receiver of the contractor's firm appointed by the court shall be unable, within fourteen days after notice to him requiring him to do so, to show to the reasonable satisfaction of the employer that he is able to carry out and fulfill the contract, and if so required by the employer to give reasonable security therefore, or if the contractor shall suffer execution to be issued, or shall suffer any payment under this contract to be attached by or on behalf of any of the creditors of the contractor, or shall

assign, charge or encumber this contract or any payments due or which may become due to the contractor there under, or shall neglect or fail to observe and perform all or any of the acts, matters or things by this contract to be observed and performed by the contractor within three clear days after the notice shall have been given to the contractor in manner hereinafter mentioned requiring the contractor to observe or perform the same or shall use improper materials or workmanship in carrying on the works, or shall in the opinion of the employer not exercise such due diligence and make such due progress as would enable the work to be completed within due time agreed upon, and shall fail to proceed to the satisfaction of the employer after three clear days notice requiring the contractor so to do shall have been given to the contractor as hereinafter mentioned, or shall abandon the contract, then and in any of the

said cases, the bank may notwithstanding previous waiver, determine the contract by a notice in writing to the effect as hereinafter mentioned, but without thereby effecting the powers of the contract the whole of which shall continue in force as fully as if the contract had not been so determined and as if the works subsequently executed had been executed by or on behalf of the contractor (without thereby creating any trust in favor of the contractor). Further the employer or his agent, or servants, may enter upon and take possession of the work and all plants, tools, scaffolding, sheds, machinery, steam and other power, utensils and materials lying upon premises or the adjoining lands or roads and sell the same as his own property or, may employ the same by means of his own servants and workmen in carrying on and completing the works or by employing any other contractors or other persons or person to complete the works, and the contractor shall not in any way interrupt or do any act, matter or thing to prevent or hinder such other contractor or other persons or person employed from completing and finishing the works. When the works shall be completed, or as soon thereafter as conveniently may be, the employer shall give notice in writing to the contractor to remove his surplus materials and plants and, should the contractor fail to do so within a period of 14 days after receipt by him, the employer may sell the same by Public Auction and shall give credit to the contractor for the amount so realized. Any expenses or losses incurred by the employer in getting the works carried out by other persons or contractors shall be adjusted against the amount payable to the contractor by way of selling his tools and plants or due on account of work carried out by the contractor prior to engaging other persons or contractors or against the Security Deposit.

Without prejudice to any of the rights or remedies under this contract if the contractor dies, the Bank shall have the option of terminating the contract without compensation to the contractor.

39. CLOSE RELATIVES

The contractor shall also intimate the names of persons who are working with him in any capacity or are subsequently employed by him or himself and who are near relative to any Employee of the Karnataka Grameena Bank or retired employees (If retired within 3 years from the date of the tender). Any breach of these conditions by the Company or Firm or any other person/ contractor, the tender/work is liable to be cancelled and Earnest Money/ Security Deposit will be forfeited at any stage, whenever it is so noticed. The Bank will not pay any damages to the company or Firm or the concerned person. The Company or Firm or the person is also liable to be debarred for further participation in the tenders in the concerned circle of the Bank. The details shall be furnished in a **separate letter**.

40. SETTLEMENT OF DISPUTES AND ARBITRATION:

- (i) It shall be an inseparable part of the contract that in matters regarding quality of materials, workmanship, or rejection of improper supply, interpretation of specifications, commitments made etc, the decision of the Bank, which shall be given in writing, shall be final, conclusive and binding on the Bidder. If the Bidder

considers that any decision of the Bank is unacceptable and issue cannot be resolved mutually, the Bidder may request for arbitration in writing within 15 days of such happening. Thereon, the Employer shall give his written instructions or decision within a period of 30 days from the receipt of the Bidder's letter.

- ii. All disputes or differences in respect of which decisions have not been final, binding and conclusive as above shall be referred for arbitration by a Sole Arbitrator in accordance with the provisions of the Arbitration and Conciliation Act, 1996. The Bank shall finalize the names of 3 Arbitrators. The Bidder has to choose ONE among them. The seat of arbitration will be at Ballari, Karnataka. The expenses of Arbitration shall be equally shared.
- iii. In the case the successful Bidder is a Central Public Sector Enterprises (CPSEs) or a Government Department, the following arbitration clause will be applicable: In the event of any dispute or difference relating to the interpretation and application of the provisions of the contracts, such dispute or difference shall be referred by either party for Arbitration to the sole arbitrator in the Department of Public Enterprises to be nominated by the Secretary to the Government of India in-charge of the Department of Public Enterprises. The Arbitration and Conciliation Act, 1996 shall not be applicable to arbitration under this clause. The award of the arbitrator shall be binding upon the parties to the dispute, provided, however, any party aggrieved by such award may make further reference for setting aside or revision of the award to the Law Secretary, Department of Legal Affairs, Ministry of Law & Justice, Government of India. Upon such reference the dispute shall be decided by the Law Secretary or the Special Secretary/Additional Secretary, when so authorized by the Law Secretary, whose decision shall bind the Parties finally and conclusively. The Parties to the dispute will share equally the cost of arbitration as intimated by the Arbitrator.

Signature of the Tenderer
With name and address

SAFETY CODE

Scaffolds

- i) Suitable scaffolds shall be provided for workmen for all works that cannot safely be done from the ground, or from solid construction except in the case of short duration work, which can be done safely from ladders. When a ladder is used, it shall be of rigid construction made either of good quality wood or steel. The steps shall have a minimum width of 450 mm and a maximum rise of 300 mm. Suitable hand holds of good quality wood or steel shall be provided and the ladder shall be given an inclination not steeper than $\frac{1}{4}$ to 1 ($\frac{1}{4}$ horizontal and 1 vertical).
- ii) Scaffolding or staging more than 4 m. above the ground floor, swung or suspended from an overhead support or erected with sanitary support shall have a guard rail properly bolted, braced or otherwise secured, at least 1 m. above the floor or platform of such scaffolding or staging shall be so fastened as to prevent it from swaying from the building or structure.
- iii) Working platforms, gangways and stairways shall be so constructed that they do no sag unduly or unequally and if the height of the platform, gangway or stairway is more than 4 m. above ground level or floor level, they shall be closely boarded and shall have adequate width and be suitably fenced as described in (ii) above.
- iv) Every opening in the floor of a building or in a working platform with suitable means to prevent the fall of persons or materials or railing whose minimum height shall be 1.00m. Whenever there are open excavations in ground, they shall be fenced off by suitable railing and danger signals installed at night so as to prevent persons slipping into the excavations.
- v) Safe means of access shall be provided to all working places. Every ladder shall be securely fixed. No portable single ladder shall be over 9 m. in length while the width between side rails in rung ladder shall in no case, be less than 290 mm, for ladder up to and including 3 m. in length. For longer ladders this width shall be increased at least 20 mm for each additional metre of length.
- vi) A sketch of the ladders and scaffolds proposed to be used shall be prepared and approval of the Engineer obtained prior to construction.

Other Safety Measures

- vii) All personnel of the contractor working within the plant site shall be provided with safety helmets. All welders shall wear welding goggles while doing welding work and all metal workers shall be provided with safety gloves. Persons employed on metal cutting and grinding shall wear safety glasses.
- viii) Adequate precautions shall be taken to prevent danger from electrical equipment. No materials on any of the sites of work shall be so stacked or placed as to cause danger or inconvenience to any person or the public.

Demolition

- ix) Before any demolition work is commenced and also during the process of the work.
 - a) All roads open areas adjacent to the work site shall either be closed or protected.
 - b) No electric cable or apparatus, which is liable to be a source of danger over a cable or apparatus used by the operator, shall remain electrically charged.
 - c) All practical steps shall be taken to prevent danger to persons employed from the risk so over loaded with debris or materials as to render it unsafe.

Personal Safety Equipments: All necessary personal safety equipment as considered adequate by the Engineer should be kept available for the use of the person employed on the site and maintained in a condition suitable for immediate use, and the contractor should take adequate steps to ensure proper use of equipment by those concerned.

- a) Workers employed on mixing asphaltic materials, cement and lime mortars shall be provided with protective footwear and protective goggles.

- b) Those engaged in white washing and mixing or stacking of cement bags or any materials, which are injurious to the eyes, shall be provided with protective goggles.
- c) Those engaged in welding works shall be provided with welder's protective eyesight lids.
- d) Stonebreakers shall be provided with protective goggles and protective clothing and seated at sufficiently safe intervals.
- e) When workers are employed in sewers and manholes, which are in use, the contractor shall ensure that the manhole covers are opened and are ventilated at least for an hour before the workers are allowed to get into manholes and the manholes so opened shall be cordoned off with suitable railing and provided with warning signals or boards to prevent accident to the public.
- f) The contractor shall not employ men below the age of 18 years. Women of any age shall not be engaged for the work of painting with products containing lead in any form. Whenever men above the age of 18 years are employed on the work of lead painting the following precautions should be taken.
- g) No paint containing lead or lead products shall be used except in the form of paste or ready-made paint.
- h) Suitable facemasks should be supplied for use by the workers when paint is applied in the form of spray or a surface having lead paint dry rubbed and scraped.
- i) Overalls shall be supplied by the contractor to the workmen and adequate facilities shall be provided to enable the working painters to wash during the cessation of work.
- j) When the work is done near any public place where there is risk of accidents all necessary equipments should be provided and kept ready for use and all necessary steps taken for prompt rescue of any person in danger and adequate provision should be made for prompt first aid treatment of all injuries likely to be sustained during the course of the work.

Witness

Signature of Contractor
Address:

APPENDIX-1: TIME SCHEDULE

1	Period of Completion	: 90 DAYS INCLUDING HOLIDAYS, SUNDAYS FROM THE DATE OF HANDING OVER THE POSSESSION OF SITE.
2	Defects Liability Period (DLP)	: 12 (Twelve) months from the date of Completion of work
3	Date of Commencement	: From the date of Work Order
4	Liquidated Damages for Delay	: As mentioned in the Clause no.13
5	Period of final measurement	: 30 (Thirty) days.
6	Value of work for Interim Certificate	: Minimum of ₹10 (Ten) Lakhs
7	Period of honoring interim Certificate	: Total 15 working days. 7 working days for Architect to certify and another 7 working days for Bank to make payment.
8	Period of honoring Final Certificate	: 30(Thirty) working Days.
9	Retention Money	: 8% of Interim Bill amount subject to the ceiling of the total security deposit
10	Total Security Deposit (Maximum)	: 10% in total
11	Initial Security Deposit including EMD	: 2% of Contract sum
12	Earnest Money Deposit	: ₹80,000/- (Rupees Eighty Thousand Only)
13	Tender validity period	: 90 days

Appendix-2
BIO DATA OF THE TENDERER

1. (a) Name of the Tenderer :
Address :

Telephone No. :
Office :
Residence :
Mobile :
Fax :
E-Mail :
- (b) Address of office :
2. a) Status of the Firm(Whether company/
Partnership / proprietary) :

a) Name of the Proprietor/ Partners/ Directors
(With professional qualifications, if any):

I)

II)

III)

b) Year of establishment :
3. Whether registered with Registrar of
Companies/ firm. If so, No. & Date :
4. Registration with Tax Authorities :

a) Income-tax No. PAN;
(Furnish copies of Income-tax returns)

b) GST Registration Number :
(Furnish the latest copies of the returns filed)

c) Authorized Dealer/ OEMs certificate if available

d) Labour License certificate if available :
5. Names of the Bankers with address :

I)
II)

Turnover of the Company/firm (Please attach copy of documents in support of the details).

Sl.No.	Year	Turnover
1	2023-24	
2	2024-25	
3	2025-26	

6. Registration / Empanelment with Government / Public Sector / Banks / Corporate if any (Copy of valid registration / empanelment copy should be enclosed).

7.

NAME OF THE ORGANISATION	NATURE OF WORKS	VALUE OF WORKS	DATE OF REGISTRATION

8. What are your fields of activities? Mention the fields on preference Basis

1)

2)

9. Details of the works executed during the last 5 years prior to 31.03.2026 to meet Eligibility Criteria.

Sl. No	Name of Work	Work executed for (name of the organization with address, concerned office and telephone number)	Nature of work (in brief)	Location of the work	Actual Value of the works	Date of commencement & Completion.

10. Key personnel permanently employed in your organization:

Sl. No	Name	Qualifications	Experience	Particulars of work done	Employed in your firm since	Any other

11. Furnish the names of three responsible clients / persons to whom the major works carried out by the applicant with address and telephone number who will be in a position to certify about the quality as well as past performance of your organization.

NAME OF THE OFFICIAL	ORGANISATION & ADDRESS	CONTACT NUMBERS

12. Furnish the details of AWARDS, CITATIONS, etc., received in recognition of your services in projects designed / associated

YEAR	Name of the Award with details	Name of the organization from whom award was received	Name of the project for which such award was received

DECLARATION:

1. All the information furnished by me / us here above is correct to the best of my knowledge and belief.
2. I / we have no objection if enquiries are made about the work listed by me / us in the accompanying sheets / annexure.
3. I / We agree that the decision of Bank in selection will be final and binding to me / us.

Place : SIGNATURE

Date : NAME & DESIGNATION

SEAL OF ORGANISATION

Appendix-3
CONTRACT AGREEMENT FORMAT

This agreement made on this _____ day of the month _____ in the year two thousand Twenty Six (____. 2026) BETWEEN, Karnataka Grameena Bank a body corporate constituted under the Regional Rural Bank Act, having its Head Office, at No.32, Gandhinagar, Ballari, amongst others a **General Administration Section, Head Office :: Ballari** represented by its duly constituted attorney (hereinafter referred to as Bank) of the **ONE PART ;**

AND

M/s. _____ duly represented by one of its Proprietor/Partner _____, aged _____ years, S/o Sri _____, residing at _____ and _____ having their office at _____ (hereinafter called the Contractor) of the

Other part.

WHEREAS THE Bank is desirous of undertaking theand has accepted the tender opened on _____.2026 submitted by the contractor & the contractor has agreed to perform as set out and subject to the terms & conditions set forth in the said documents mentioned herein under.

NOW THIS AGREEMENT WITNESSETH as follows:

1. In this agreement words and expression shall have the same meanings as are respectively assigned to them in the conditions of contract hereinafter referred to.
2. The following documents not inconsistent with these presents shall be deemed to form and be read and construed as part of this agreement viz.,
 - a) The Tender Document comprising Notice inviting the tender , General rules & Instruction to tenderers, General Conditions of the Contract, Special; conditions , Appendix 1 to .. , Priced schedule of quantities, Tender Drawings.
 - b) Corrigendum to tender document if any.
 - c) Letter from contractor dt. _____ in response to the negotiation meeting discussions held on _____
 - d) Letter of Acceptance issued to contractor by Bank - letter No. _____ dt.....
 - e) Letters from and to the Contractor, if any, leading to and prior to acceptance letter.

3. In consideration of the payments to be made by the Bank to the Contractor the Contractor hereby covenants and agrees with the Bank to execute, complete and perform the works in conformity in all respects with the Tender document as mentioned in the aforesaid documents which shall form part of this agreement.

In witness whereof, the parties hereunto have set their respective hands and seals the day and year first above written.

For & on behalf of the
Contractor with seal

For & on behalf of the
Karnataka Grameena Bank with seal



Appendix-4
INDEMNITY BOND FORMAT

THIS DEED OF INDEMNITY BOND executed at RANCHI on this _____ day of _____ month of year two thousand and twenty Six (2026) By M/s _____ duly represented by proprietor / one of its partners Sri _____, aged _____ years, son of Sri _____, residing at _____..

In favour of

Karnataka Grameena Bank, a body corporate constituted under the RRB Act, having its Head Office, at No.32, Gandhinagar, Ballari.

Where as I am the authorised partner of M/s _____, and had applied for prequalification of contractors for

Whereas as my company was shortlisted for issue of tenders and my company became successful in securing the subject work through competitive tendering and the work of has been awarded in our favour by Karnataka Grameena Bank, Head office vide their letter

And where as for undertaking the work, my company has entered into contract agreement with Karnataka Grameena Bank on_.

Now this Deed Witnessed that in pursuance of the aforesaid contract agreement **dt.** _____ and in consideration of Karnataka Grameena Bank having agreed to make payments on the bills claimed by me/my company based on the works completed by me/my company in respect of and referred to above,

I hereby undertake to indemnify and keep harmless the Karnataka Grameena Bank & its Architect and its officials/ staff from any damages, prosecution, other legal suits and claims arising out of any mishaps occurring at the site due to faulty work, faulty construction and for violating rules and regulations, any possible damage to the building and members of public in course of execution of the work **for which I shall be solely responsible.**

Signature of Contractor with seal



Appendix-5
Bank Guarantee Format for Earnest Money Deposit

To
The General Manager,
Karnataka Grameena Bank,
General Administration Wing,
Head Office :: BALLARI

WHEREAS _____ (Name of Tenderer) (hereinafter called "the Tenderer" has submitted its tender dated _____ (Date) for the execution of (Name of Contract) _____ (hereinafter called "the Tender") in favour of **KARNATAKA GRAMEENA BANK, Head office, Ballari** hereinafter called the "Beneficiary";

KNOW ALL MEN by these presents that we, _____ (name of the issuing Bank), a body corporate constituted under the _____ having its Head Office at _____ amongst others a branch / office at _____ (hereinafter called "the Bank" are bound unto the Beneficiary for the sum of Rs _____ (Rupees _____ only) for which payment well and truly to be made to the said Beneficiary, the Bank binds itself, its successors and assigns by these presents;

THE CONDITIONS of this obligation are:

- (a) If the Tenderer withdraws its Tender during the period of Tender validity specified in the Tender; or
- (b) If the Tenderer having been notified of the acceptance of his Tender by the Beneficiary during the period of Tender validity;
 - (i) fails or refuses to execute the Agreement, if required; or
 - (ii) fails or refuses to furnish the performance security, in accordance with clause _____ of conditions of Contract.

We undertake to pay to the Beneficiary up to the above amount upon receipt of his first written demand without the Beneficiary having to substantiate his demand, provided that in his demand the Beneficiary will note that the amount claimed by him is due to him owing to the occurrence of one or both of the two conditions, specifying the occurred condition or conditions.

Notwithstanding anything contained herein

- i) Our liability under this Bank Guarantee shall not exceed Rs. _____ (Rupees _____ only)
- ii) This Bank Guarantee is valid up to _____ and
- iii) We are liable to pay the guaranteed amount or any part thereof under this Bank Guarantee only and only if you serve upon us a written claim or demand on or before _____ (mention period of guarantee as found under clause (ii) above plus claim period)

Dated _____ day of _____ 2026

SIGNATURE & SEAL OF THE BANK



Appendix-6
BANK GUARANTEE FORMAT FOR SECURITY DEPOSIT

Guarantee No.....
Amount of Guarantee Rs.....
Guarantee cover from Dated:
To Dated:
Last Date for Lodgement of claim:

To:

In consideration of (hereinafter called "Beneficiary") having agreed to exempt Ltd., having its Registered Office situated at (hereinafter called the "the obligator(s)") from the demand of security deposit of Rs..... (Rupees only) under the terms and conditions of an agreement dated..... (hereinafter called the "said Agreement") for the due fulfillment by the said obligator of the terms and conditions contained in the said agreement, on production of the Bank Guarantee for Rs..... (Rupees only), at the request of the obligator Bank, a body corporate constituted under the Banking Companies (Acquisition & Transfer of undertakings) Act, 1970 having its Head Office at _____ amongst others a branch at (hereinafter referred to as "the Bank") has agreed to give following guarantee in favour of the beneficiary for an amount not exceeding Rs..... (Rupees only) against any loss or damage caused to or suffered or would be caused to or suffered by reason of any breach by the said Obligator(s) of any of the terms and conditions contained in the said agreement.

1. We, the Bank to hereby undertake to pay the amount payable under this guarantee without any demur merely on a demand from the beneficiary stating that the amount claimed is due by way of loss or damage caused to or would be caused to or suffered by reason or any breach of the terms and conditions contained in the said agreement or by reason of the obligator's failure to perform the said agreement. Any such demand in writing made on the Bank shall be conclusive as regards the amount due and payable by the Bank under the guarantee. However, our liability under this guarantee shall be restricted to an amount not exceeding Rs.....
2. We, the Bank further agree that the guarantee herein contained shall remain in full force and effect during the period that would be taken for the performance of the said agreement and that it shall continue to be enforceable till all the dues of the beneficiary under or by virtue of the said agreement have been fully paid and its claims satisfied or till the beneficiary certifies that the terms and conditions of the said agreement have been fully discharged this guarantee. Unless a demand for claim under this guarantee is made on us in writing on or before we shall be discharged from all liabilities under this guarantee thereafter.
3. We, the Bank further agree that the beneficiary shall have the fullest liberty, without consent and without effecting in any manner or obligations hereunder, to extend time of performance the said obligator(s) from time to time or to postpone for any time any of the powers exercisable by the beneficiary against the said obligator(s) and to forbear or enforce any of the terms and conditions relating to the said agreement and



we shall not be relieved of our liability by reason of any extension being granted to the said obligator(s) for any forbearance, act or omission on the part of the beneficiary or any indulgence by the beneficiary to the said obligator(s) or by any such matter or thing whatsoever which under the law relating to sureties would not for this provision have effect of so relieving us.

4. We, the Bank lastly undertake not to revoke this guarantee during its currency except with the previous consent of the beneficiary in writing.
5. Notwithstanding anything contained herein:
 - (i) Our liability under this Bank Guarantee shall not exceed Rs.
(Rupees..... only)
 - (ii) This Bank Guarantee is valid upto and
 - (iii) We are liable to pay the guaranteed amount or any part thereof under this Bank Guarantee only and only if you serve upon us a written claim or demand on or before.....(mention period of the guarantee as found under clause (ii) above plus claim period)

PLACE:

DATE:

SIGNATURE



Appendix-7
UNDERTAKING LETTER IN YOUR LETTER HEAD WITH TECHNICAL BID

To,
The General Manager, Karnataka
Grameena Bank
General Administration Wing Head
Head Office :: Ballari

**SUBJECT: Tender For Civil-Plumbing Work and Repair/Renovation Works at Bank
Owned Premises at Head office annex, Dharwad**

Dear Sir,

This has reference to your above RFP published in your banks website and CPPP web site.

We hereby state that we M/s_____ have submitted the above offer documents duly filling at the appropriate places without making any alterations , corrections , omissions in the offer issued by the bank or downloaded from the web site.

Signature & Name of the Bidder with seal



Appendix- 8
(DECLARATION TO BE SUBMITTED ON LETTER HEAD OF THE BIDDER)

Ref: Tender For Civil-Plumbing Work and Repair/Renovation Works at Bank Owned Premises at Head office annex, Dharwad

I / We hereby declare that I / We have not been banned or blacklisted or debarred by any Government , Quasi Government Agencies, Public Sector Undertakings or Private Companies anywhere, anytime.

Should it be observed anytime during currency of the bidding process or during execution of the work that I / We have been banned, blacklisted or debarred by any of the above Agencies, then I / We agree for termination of the contract forthwith and also agree for forfeiture of our Earnest Money Deposit and Security cum Performance Deposit, if any, by Karnataka Grameena Bank, without any recourse.

Dated:

Signature & Name of the Bidder with seal

APPENDIX-9
APPROVED BRANDS & MATERIALS

Unless otherwise mentioned specifically, the contractor should get the approval of the Bank before using the materials. All makes/ brands shall be BIS marked wherever applicable and shall be of the First Quality. Wherever contractor proposes to use equivalent makes (i.e. other than specified), the same shall be done only after prior approval of the Bank. Any additional expenditure and time due to this shall be solely on contractor's account and no claims whatsoever shall be entertained.

S.No.	Materials	Approved Make / Brands
A	Civil works	
1	Cement	O.P.C. Grade 43 Ultra tech, ACC ,Ambuja , Dalmia ,L&T ,Corromandel equivalent.
2	Bricks	Ordinary clay bricks of any brand.
3	SAND	RIVER SAND & WATER WASH M SAND
4	Syporex brick blocks	Shirke or equivalent
5	Polymer Latex, Rust Removers, Rust Passivator Plasticiser, Bonding solution and Crack filler	Sunanda, Fosroc, M.C. Bauchemie, Sika, Pidilite
6	Waterproofing compound	Sunanda, Fosroc, M.C. Bauchemie, Sika, Pidilite Sika, Cera, Asian, Pidilite,BIRLA
7	White Cement	Birla, J.K. White
8	Wall putty	Biral, J.K.
9	G.I. pipes	Tata 'C' class only OR EQUIVALENT
10	CPVC/ UPVC pipes	Finolex, Astra, Supreme
11	G.I. fittings	R brand, Zoloto, Unique
12	Fixtures for CPVC/ UPVC pipes	Finolex, Astra, Supreme
13	Cement based paint	Snowcem, Nitcocem
14	Acrylic paint	Asian paints Apex, Snowcryl XT, Berger
15	Enamel paint/ OBD	Asian, Nerolac, berger
16	Tiles/ vitrified tiles	Johnson, RAK, Nitco ,Kajaria, Regent , Naveen Tiles (Premiumquality only)
17	Ceramic tiles	Johnson, Nitco, Kajaria, Somany, Regent, Naveen Tiles
18	Sanitaryware	Hindware, Parryware, Jaguar
19	Plumbing fixtures	Jaguar ESSCO or equivalent Parryware , HINDWARE
20	Stainless Steel Sink	Hindware, Nirali, Butterfly, Parryware, Frankie NParryware
21	Reinforcement / Tubular Section	TATA / JINDAL / RINL / SAIL/SHYAM
22	Galvalume Roofing Sheet	TATA Bluescope or similar as approved by Bank
22	tank	Sintex, Plasto,Supreme equivalent
23	Paints	Asian, British, Duco, Berger, Nerolac
24	Hardwares - Locks	Godrej, Ebco, Ozone
25	Hardwares - Handles	Hafele, Hettich, Dorma, Ozone
26	Hardwares - Hinges	Godrej, Ebco, Everite, Kaff

27	Hardwares - Ball bearing slides / channels	Hafele, Hettich, Kaff, Godrej, Ozone
28	Furniture fittings (Door stoppers, magnet catch)	Godrej, Ebco, Everite
29	Casing & capping	Good quality with ISI mark
30	PVC Conduits	Good quality with ISI mark
31	Commercial/BWR/BWP plywood and blockboards	Century Ply, Green Ply, Anchor Board, Trojan, Frontier Ply, ASIS, ArchidPly.
32	Adhesive	FEVICOL, vamicol, araldite
33	Glass	Asai, Modi, Saint Gobain
34	Hinges, Tower Bolts, Handles	BRASS OXIDISED/EPOXY POWDER COATED (HEAVY DUTY) WITH STEEL PIN
35	Aluminium Composite Panel	Eurobond, Alcobond, Durabuild

NOTE: Any brands indicated under the items specifications in the bill of quantities will prevail over the above indicated makes. Apart from the above makes, any further equivalent make as approved by the Bank, can also be used with prior permission from the Bank and Architect.

SIGNATURE OF THE TENDERER

APPENDIX-10
PLAN

1. PLAN - GROUND FLOOR

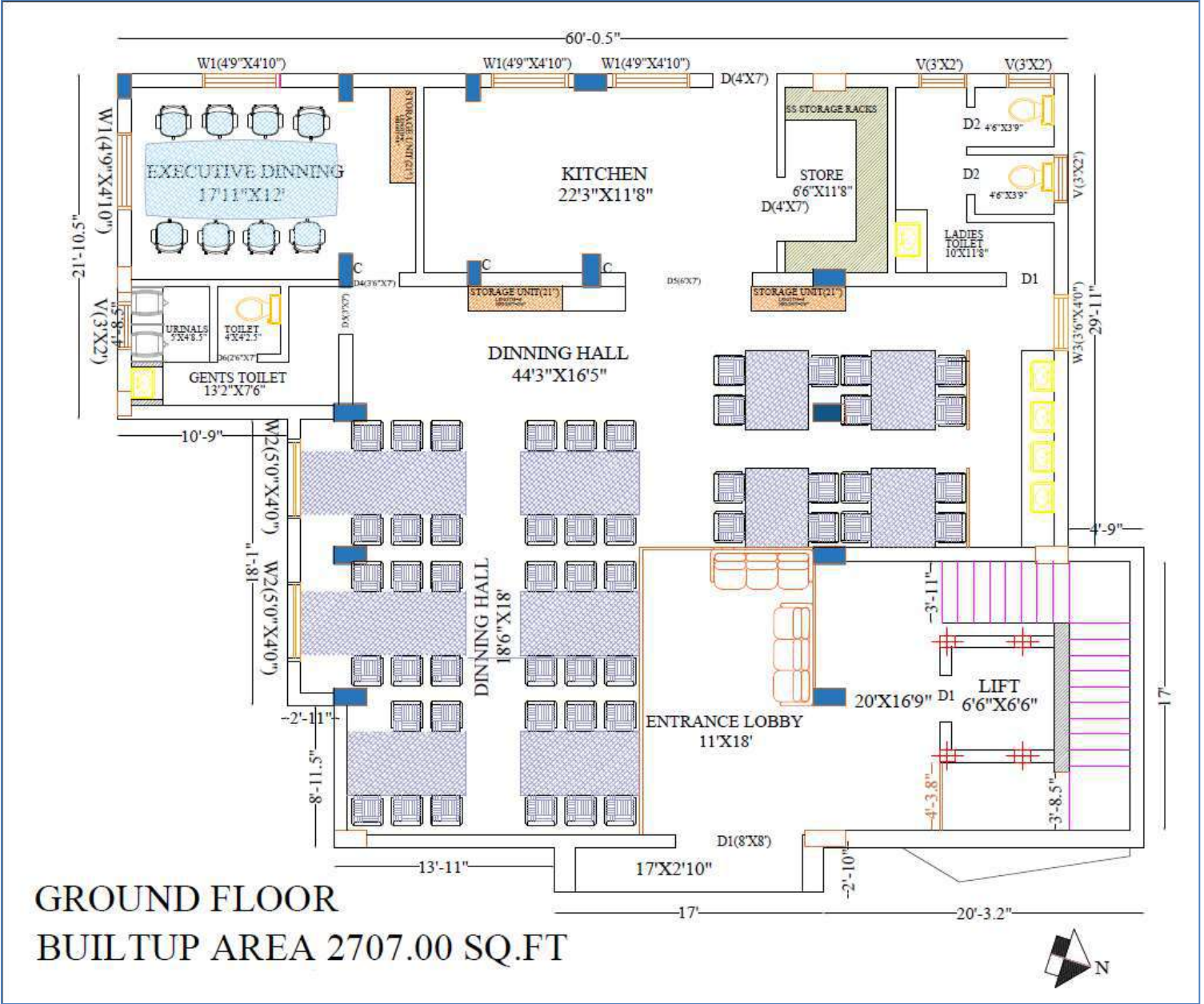

2. PLAN - FIRST FLOOR

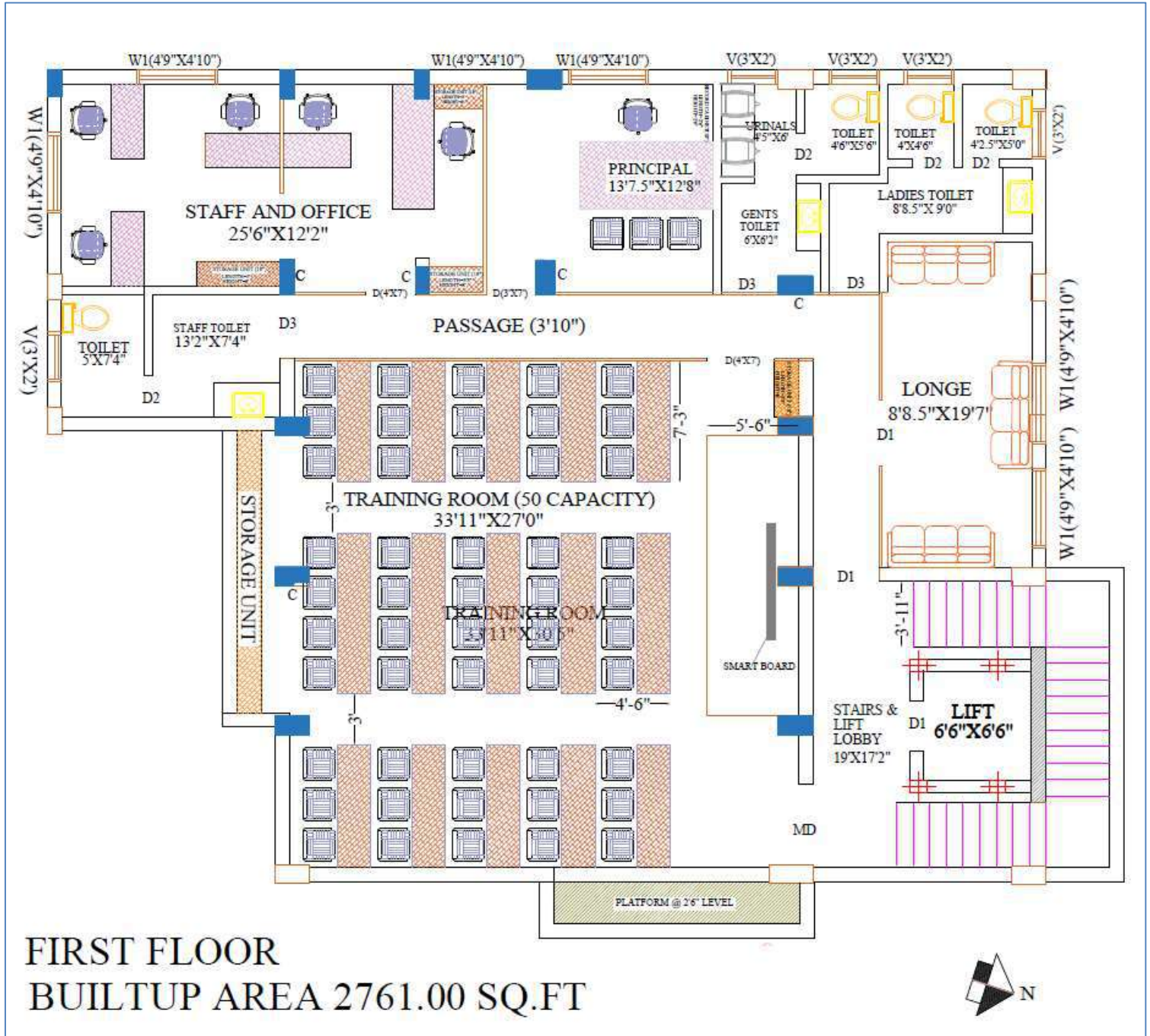

3.PLAN - SECOND FLOOR:

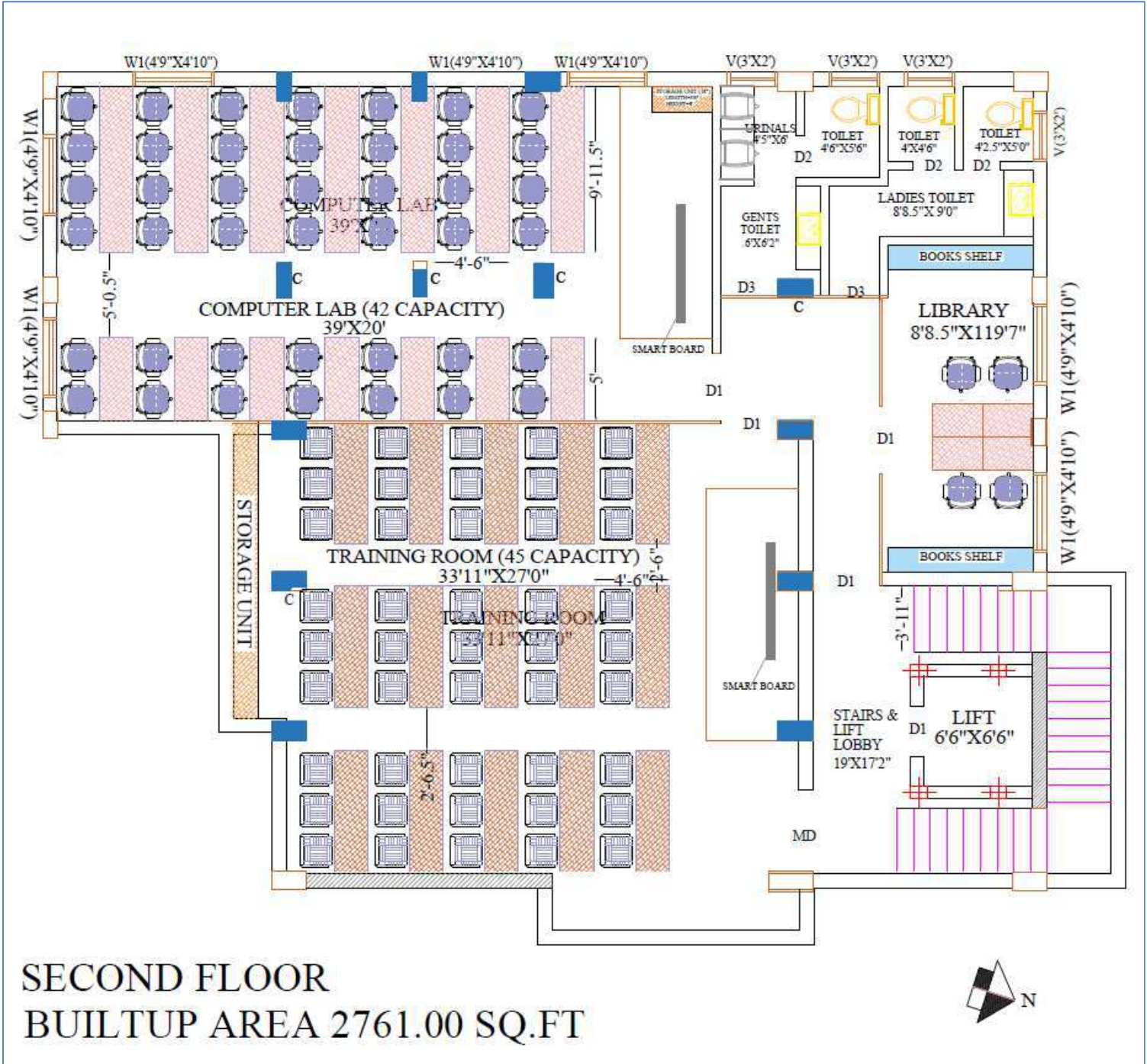

SECOND FLOOR
BUILTUP AREA 2761.00 SQ.FT



BILL OF QUANTITIES

The bill of quantities shall be read in conjunction with the drawings, Conditions of and Specifications as these documents are jointly explanatory and descriptive of the works included in the Contract.

General directions and descriptions of work and materials given elsewhere in the Contract documents are not necessarily repeated in the Bill of Quantities, reference is to be made to the other documents for information.

The Quantities of work and material in the Bill of Quantities are not to be considered as limiting or extending the scope of work to be done and materials to be supplied by the contractor. The quantities in the Bill of Quantities are an estimate of the amount of work but the work will be measured on complete and the contractor will be paid on the actual measurement of work approved by the Engineer.

Where price have been entered against Lump sum items, payment for such affected items shall be made in proportion to the extent of which at the time of billing, works have been done at the discretion of the Engineer.

'Providing and Fixing' / 'Providing and Laying' / 'Providing and Erecting' shall mean that the contractor has to provide such materials not being procured and borne by the Employer, but which are required for the item and if no material need be provided by the Contractor, the rate shall be on for fixing/ laying/ erecting of the component covered in the item.

The work also includes separating and stacking serviceable material anywhere in the compound as directed and lowering and carting away all unserviceable material debris from the site.

The acronyms used in the Bill of Quantities.

Sqm	Square meter area
Cu.mtr	Cubic meter
SFT	Square feet area
m/ rmt	Running meter
RFT	Running Feet
CFT	Cubic Feet Volume
Kg.	Kilogram
LS	Lumpsum
Nos../ No	Numbers
Architect/ consultant	Architect/ Bank Engineer
NO	Number(Quantity)

Annexure with detailed measurements are available on Bank's website as mentioned above.

PART II - FINANCIAL BID
(To be submitted in Separate Cover)

BILL OF QUANTITY (BOQ)/SCHEDULE OF CIVIL WORK AT HEAD OFFICE-ANNEX, KARNATAKA GRAMEENA BANK, DHARWAD.

SL. NO.	DESCRIPTION	UNIT	QTY	RATE (INCL. LABOUR & MATERIAL)	AMOUNT
				Rs.Ps	Rs.Ps
A	CIVIL WORK				
	LIFT ALL FLOORS				
1	EARTH WORK FOR LIFT				
	Earth work excavation for Foundation by Manual means depth upto 2.5m, as per drawing and technical specifications, including setting out, shoring, strutting, barricading, caution lights, including cost of explosives, dressing of excavated surfaces, disposing off or levelling the excavated stuff or sorting & stacking the selected stuff for reuse in a radius of 200 m and lift upto 2.5m including cost of labour, blasting materials, tools, usage of Machinery & all other appurtenances required to complete the work and Specifications as per KPWD SR SL NO 1.16 VOL1 PAGE 9 , etc. complete.	CFT	448.00		
2	LIFT BED CONCRETE WITH M10 GRADE				
	Providing and laying in position Cement Concrete for levelling course for all works in foundation. The granite/trap/basalt crushed graded coarse aggregates and fine aggregates as per relevant IS Codes machine mixed, laid in layers not exceeding 150 mm thickness, well compacted using plate vibrators, including all lead & lifts, cost of all materials of quality, labour, Usage charges of machinery, curing, and all the other appurtenances required to complete the work as per technical specifications. Mix 1:3:6 Using 40 mm nominal size graded crushed coarse aggregates and Specifications as per KPWD SR SL NO 2.1 (2.1.3) VOL1 PAGE15 , etc. complete.	CFT	32.00		
3	LIFT FLOORING CONCRETE & LIFT RCC WALL CONCRETE WITH M20 GRADE				
	Providing and laying in Cement Concrete for all Basement & surface level works, return walls, retaining walls, sunken floors, lift pit footing , flooring & side walls , plinth beam, etc. The granite/trap/basalt crushed graded coarse aggregates and fine aggregates as per relevant IS Codes machine mixed with super plasticisers, laid in layers, well compacted using needle vibrators, providing weep holes wherever necessary, including all lead & lifts, cost of all materials of quality, labour, Usage charges of machinery, curing and all other appurtenances required to complete the work as per technical specifications. (KPWD SR SL NO 2.3 VOL1 PAGE 15)				

	M20 Design Mix Using 20 mm nominal size graded crushed coarse aggregates and Specifications as per KPWD SR SL NO 2.3.1 VOL1 PAGE 16 , including shuttering work & Scaffolding , etc. complete.				
	LIFT FLOORING CONCRETE	CFT	96.00		
	LIFT RCC WALL CONCRETE	CFT	105.27		
4	LIFT RCC COLUMNS CONCRETE ,LIFT RCC LINTEL CONCRETE & LIFT RCC BEAM CONCRETE WITH M20 GRADE				
	Providing and laying in position Cement Concrete for all Super structures of building including columns , lintel, beam, roof , sunshade, Road works, Water works, Irrigation works & super structure works of bridges upto 3.50 m height. The granite/trap/basalt crushed graded coarse aggregates and fine aggregates as per relevant IS Codes machine mixed with super plasticisers laid in layers, well compacted using needle vibrators. The cost includes all lead & lifts, cost of all materials, quality confirming to the requirements of relevant IS codes , labour, Usage charges of machinery, curing and all other appurtenances required to complete the work as per technical specifications. (KPWD SR SL NO 2.5 VOL1 PAGE 16) M20 Design Mix Using 20 mm nominal size graded crushed coarse aggregates and Specifications as per KPWD SR SL NO 2.5.1 VOL1 PAGE 16 , including shuttering work & Scaffolding, etc. complete.				
a	LIFT RCC COLUMNS CONCRETE	CFT	105.60		
b	LIFT RCC LINTEL CONCRETE (M20)	CFT	13.07		
c	LIFT RCC BEAM CONCRETE (M20)	CFT	75.00		
d	PLINTH BEAM CONCRETE (M20)	CFT	1.56		
5	STEEL REINFORCEMENT INCL. BINDING WIRE FOR LIFT RCC WALL,FLOORING & RCC COLUMNS, RCC BEAM, RCC LINTEL.				
	Supplying, fitting and placing TMT FE 500 / 550D Steel Reinforcement including cost of all materials, machinery, labour, cleaning, straightening, cutting, bending, hooking, laping/welding joints, tying with binding wire / soft annealed steel wire and other ancillary operations complete, including Scaffolding, wastage of material, as per drawing and technical specification. and Specifications as per KPWD SR SL NO 2.11 (a) VOL1 PAGE 18 , etc. complete.	KG	1100.00		
6	FOR LIFT WALL 8" CEMENT BLOCK WALL IN (1:4) CEMENT MORTER				
	Providing and constructing load bearing wall with Solid Concrete blocks of size 400x200x200mm having block density more than 1800kg/m3 and minimum compressive strength of 4.00 N/mm2 conforming to IS 2185 (Part - I) - 2005 and constructed with CM 1:4 as per IS 2572:2005	SFT	1153.00		

	including cost of all materials, labour, scaffolding and curing, usage charges of machinery etc complete as per specifications. and Specifications as per KPWD SR SL NO 6.32 VOL2 PAGE 17 , etc. complete.				
7	PLASTERING				
	Providing 25 mm cement plaster of mix :1:4 (1 cement: 4 fine sand) to brick/stone masonry including rounding off corners wherever required smooth rendering, providing and removing scaffolding, including cost of materials, labour, curing complete as per specifications and as per directions of Engineer-in-charge.and Specifications as per KPWD SR SL NO 8.3.1 VOL2 PAGE 41 , etc. complete.	SFT	2513.00		
8	PAINTING				
	INTERIOR PAINT : Wall painting with 2 coats of premium acrylic emulsion paint of interior grade, having VOC (Volatile Organic Compound) content less than 50 g/L of approved brand and manufacture, including applying additional coats wherever required to achieve even shade and colour over 2 coats of putty & 1 coat of primer. Providing and applying white cement based 2 coat of putty to provide average thickness 1 mm, of approved brand and manufacturer, over the plastered wall surface to prepare the surface even and smooth complete as per specifications and as per directions of Engineer in charge. Applying priming coat with 1 coat of primer of approved brand and manufacture, having low VOC (Volatile Organic Compound) content. 2 coats premium acrylic emulsion paint as per specifications and to give an even approved shade after thoroughly brushing the surface, free from mortar drops & other foreign matter including preparing the surface even with sand paper including cost of materials, labour scaffolding etc., complete as per directions of Engineer in charge. and Specifications as per KPWD SR SL NO 8.54.2 , 8.55.1, 8.51 VOL2 PAGE 50 , etc. complete.	SFT	2145.00		
	GROUND FLOOR				
1	EARTH WORK FOR FOUNDATION FOR 6" CEMENT BLOCK WALL				
	Earth work excavation for Foundation by Manual means depth upto 2.5m, as per drawing and technical specifications, including setting out, shoring, strutting, barricading, caution lights, including cost of explosives, dressing of excavated surfaces, disposing off or levelling the excavated stuff or sorting & stacking the selected stuff for reuse in a radius of 200 m and lift upto 2.5m including cost of labour, blasting materials, tools, usage of Machinery & all other appurtenances required to complete the work and Specifications as per KPWD SR SL NO 1.16 VOL1 PAGE 9 , etc. complete.	CFT	480.00		
2	PCC BED (M-10) FOR FOUNDATION FOR 6" CEMENT BLOCK WALL				
	Providing and laying in position Cement Concrete for levelling course for	CFT	79.20		

	all works in foundation. The granite/trap/basalt crushed graded coarse aggregates and fine aggregates as per relevant IS Codes machine mixed, laid in layers not exceeding 150 mm thickness, well compacted using plate vibrators, including all lead & lifts, cost of all materials of quality, labour, Usage charges of machinery, curing, and all the other appurtenances required to complete the work as per technical specifications. Mix 1:3:6 Using 40 mm nominal size graded crushed coarse aggregates and Specifications as per KPWD SR SL NO 2.1 (2.1.3) VOL1 PAGE15 , etc. complete.				
3	SIZE STONE MASONARY				
	Providing Random rubble masonry with hard stone in foundation and plinth including levelling up with cement concrete 1:6:12 (1 cement : 6 coarse sand : 12 graded stone aggregate 20 mm nominal size) upto plinth level with : Providing Size Stone masonry with hard stone in foundation with Cement mortar 1:6 (1 cement : 6 coarse sand) and Specifications as per KPWD SR SL NO 5.1 & 5.4 VOL2 PAGE 9 , etc. complete.	CFT	480.00		
4	RCC (M-20) PLINTH BEAM FOR 6" CEMENT BLOCK WALL IN (1:4) CEMENT MORTER				
	Providing and laying in Cement Concrete for all Basement & surface level works, return walls, retaining walls, sunken floors, lift pit footing , flooring & side walls , plinth beam, etc. The granite/trap/basalt crushed graded coarse aggregates and fine aggregates as per relevant IS Codes machine mixed with super plasticisers, laid in layers, well compacted using needle vibrators, providing weep holes wherever necessary, including all lead & lifts, cost of all materials of quality, labour, Usage charges of machinery, curing and all other appurtenances required to complete the work as per technical specifications. (KPWD SR SL NO 2.3 VOL1 PAGE 15) M20 Design Mix Using 20 mm nominal size graded crushed coarse aggregates and Specifications as per KPWD SR SL NO 2.3.1 VOL1 PAGE 16 , including shuttering work & Scaffolding , etc. complete.	CFT	158.40		
5	DINING HALL FLOORING CONCRETE WITH M-20 GRADE				
	Providing and laying in Cement Concrete for all Basement & surface level works, return walls, retaining walls, sunken floors, lift pit footing , flooring & side walls , plinth beam, etc. The granite/trap/basalt crushed graded coarse aggregates and fine aggregates as per relevant IS Codes machine mixed with super plasticisers, laid in layers, well compacted using needle vibrators, providing weep holes wherever necessary, including all lead & lifts, cost of all materials of quality, labour, Usage charges of machinery, curing and all other appurtenances required to complete the work as per technical specifications. (KPWD SR SL NO 2.3 VOL1 PAGE 15) M20 Design Mix Using 20 mm nominal size graded crushed coarse aggregates and Specifications as per KPWD SR SL NO 2.3.1 VOL1 PAGE 16 , including shuttering work & Scaffolding , etc. complete.	CFT	762.06		

6	6" CEMENT BLOCK WALL IN (1:4) CEMENT MORTER				
	Providing and constructing load bearing wall with Solid Concrete blocks of size 400x150x200mm having block density more than 1800kg/m3 and minimum compressive strength of 4.00 N/mm2 conforming to IS 2185 (Part - I) - 2005 and constructed with CM 1:4 as per IS 2572:2005 including cost of all materials, labour, scaffolding and curing, usage charges of machinery etc complete as per specifications. and Specifications as per KPWD SR SL NO 6.33 VOL2 PAGE 17 , etc. complete.				
	GROUND FLOOR	SFT	1316.17		
	FIRST FLOOR	SFT	847.83		
	SECOND FLOOR	SFT	687.89		
7	PLASTERING				
	Providing 25 mm cement plaster of mix :1:4 (1 cement: 4 fine sand) to brick/stone masonry including rounding off corners wherever required smooth rendering, providing and removing scaffolding, including cost of materials, labour, curing complete as per specifications and as per directions of Engineer-in-charge.and Specifications as per KPWD SR SL NO 8.3.1 VOL2 PAGE 41 , etc. complete.				
	GROUND FLOOR	SFT	2425.34		
	FIRST FLOOR	SFT	1600.65		
	SECOND FLOOR	SFT	1280.78		
8	PAINTING				
	INTERIOR PAINT : Wall painting with 2 coats of premium acrylic emulsion paint of interior grade, having VOC (Volatile Organic Compound) content less than 50 g/L of approved brand and manufacture, including applying additional coats wherever required to achieve even shade and colour over 2 coats of putty & 1 coat of primer. Providing and applying white cement based 2 coat of putty to provide average thickness 1 mm, of approved brand and manufacturer, over the plastered wall surface to prepare the surface even and smooth complete as per specifications and as per directions of Engineer in charge. Applying priming coat with 1 coat of primer of approved brand and manufacture, having low VOC (Volatile Organic Compound) content. 2 coats premium acrylic emulsion paint as per specifications and to give an even approved shade after thoroughly brushing the surface, free from mortar drops & other freign matter including preparing the surface even with sand paper including cost of materials, labour scaffolding etc., complete as per directions of Engineer in charge. and Specifications as per KPWD SR SL NO 8.54.2 , 8.55.1, 8.51 VOL2 PAGE 50 , etc. complete.				
	GROUND FLOOR	SFT	1924.13		
	FIRST FLOOR	SFT	1055.69		

	SECOND FLOOR	SFT	833.37		
9	DOORS & VENTILATORS				
i)	DOOR WITH MS COLLAPSIBLE SHUTTER GATE (INCL. PAINTING)				
	Providing and fixing 1 mm thick M.S.sheet, M.S. collapsible shutter gate (M.S.sheet sliding-shutters), with frame and diagonal braces of 40x40x6 mm angle iron, 3 mm M.S. gusset plates at the junctions and corners, 25 mm dia pulley, 40x40x6 mm angle and T- iron guide at the top and bottom respectively, including 2 coat of approved make enamel paint over applying a priming coat of approved steel primer after thoroughly brushing the surface, free from mortar drops & other foreign matter including preparing the surface even with sand paper including cost of materials, labour scaffolding etc., usage charges of machinery complete as per specifications and as per directions of the Engineer-in-Charge and Specifications as per KPWD SR SL NO 11.4 VOL2 PAGE 77 , etc. complete.				
a	1 NOS. 8' X 8'	SFT	64.00		
ii)	MS DOOR FRAME & M.S.SHUTTER (INCL. PAINTING)				
	1.Providing and fixing M.S.shutter with 1mm thick M.S. sheet door with frame of 40x40x6mm angle iron and 3 mm M.S. gusset plates at the junctions and corners, all necessary fittings complete,including 2 coat of approved make enamel paint over applying a priming coat of approved steel primer after thoroughly brushing the surface, free from mortar drops & other foreign matter including preparing the surface even with sand paper . Using M.S. angels 40x40x6 mm for diagonal braces including cost of materials, labour, usage charges of machinery complete as per specifications and as per directions of the Engineer-in Charge. (KPWD SR SL NO 11.5.1 VOL2 PAGE 77) and 2.Providing and fixing M.S.Frames with angle iron frames for doors, windows and ventilators of mild steel Angle sections of size 40x40x6 mm, joints mitred and welded by angle iron 40x40x6 mm or 40x 5 mm flat pieces to the existing T-iron frame or to the wall with dash fastener, including fixing of necessary butt hinges and screws and applying a priming coat of approved steel primer, all complete as per the direction of Engineer-In-charge including cost of materials, labour, usage charges of machinery complete as per specifications. and Specifications as per KPWD SR SL NO 11.31 VOL2 PAGE 86 , etc. complete.				
a	1 NOS. 4' X 7'	SFT	28.00		
b	1 NOS. 4' X 7'	SFT	28.00		
iii)	DOOR WITH WPC SHUTTER & FRAME (INCL. PAINTING)				
	Providing and fixing factory made Green certified, Anti Termite, UV resistant, high water absorbant single extruded WPC (Wood PolymerComposite) solid plain flush door shutter of required size comprising of virgin polymer of K value 58-60 (Suspension Grade), calcium carbonate and natural fibers (wood powder/rice husk/wheat husk) and non toxic additives (maximum toxicity index of 12 for 100 g) having minimum density of 650 kg/m3 and screw withdrawal strength of 1800 N (Face) & 900 N (Edge), minimum				

	compressive strength of 50 N/mm ² , modulus of elasticity 850 N/mm ² and resistance to spread of flame of Class A category with property of being termite/borer proof, water/moisture proof and fire retardant and fixing with stainless steel butt hinges of required size with necessary full body threaded star headed counter sunk S.S screws . painting including Surface cleaning , drying, and making dust freedust-free. Holes or indentations to be filled with wood putty . The surface must be rubbed down with sandpaper and cleaned before applying paint. Apply 1 coat of Primer with Ready-mixed pink or grey wood primer, conforming to IS 3536-1966 (for hardwood/softwood). Apply two or more coats of synthetic enamel paint of approved brand (e.g., Asian/ Berger/ Dulux/ Nerolac).The cost includes cost of materials, fixtures, painting, transportation, labour and fixing charges. Cost of Fixtures included and Specifications as per KPWD SR SL NO 12.94 VOL2 PAGE 111-112) 30 mm thickness and Specifications as per KPWD SR SL NO 12.94.1 VOL2 PAGE 111-112 , etc. complete.				
a	10 NOS. 2'6" X 7'				
b	2 NOS. 3' X 7'				
	TOTAL QTY	SFT	217.00		
10	UPVC 2 TRACK WINDOWS & VENTILATOR & MS GRILL				
	Providing & fixing of 2-track x 2-panel sliding windows made out of multichambered UPVC (Matching to RAL-9016) sections and with minimum TiO ₂ (Titanium Dioxide) at 6PHR with TPE(Thermo Plastic Elastomer) and lead free, gaskets -grey colour having isolated drainage and reinforced with Galvanized Iron profile through-out the window frame. The outer frame having an overall size of 50mm width x 42mmheight with reinforcement of 1mm thickness and Sash with overall size of 31mm X 57mm with Gi reinforcement of 1mm for the frame and 1.5 mm for the sash. Coextruded Glazing bead for fixing of glass shall be of size 21.5mm x 9.5 mm. Windows shall be provided with 5mm plain float glass, standard hardware& single point locking system with touch lock. Wall thickness of frame & sash shall be of 1.8+-0.2 mm. Maximum possible size - 1519mm x 1519mm. (The cost is inclusive of all fixtures and separate charges for minor T&P's shall not be made) and Specifications as per KPWD SR SL NO 12.86 VOL2 PAGE 109) and Providing and fixing M.S. grills of required pattern in frames of windows etc. with M.S. flats, square or round bars etc. including 2 coat of approved make enamel paint over applying a priming coat of approved steel primer after thoroughly brushing the surface, free from mortar drops & other freign matter including preparing the surface even with sand paper . etc, complete. Fixed to openings with rawl plugs screws etc. and Specifications as per KPWD SR SL NO 11.34B VOL2 PAGE 86 ,including Scaffolding, etc. complete.				
a	WINDOWS : 2 NOS. 5' X 4'	SFT	40.00		
b	WINDOWS : 1 NOS. 3'6" X 4'	SFT	14.00		
c	VENTILATOR : 15 NOS. 2'6" X 2'	SFT	75.00		
d	MS GRILL WITH ENAMEL PAINTING	SFT	129.00		
11	TILES WORK				

a	GROUND FLOOR DINING HALL FLOORING 24"X24" DOUBLE CHARGED VITRIFIED TILES				
	Providing and laying double charged vitrified floor tiles with thickness 9-10 mm in 600mmx600mm size with water absorption less than 0.08% and conforming to IS: 15622, of approved make, in all colours and shades, laid with spacers on 20mm to 40mm thick cement mortar 1:4 (1 cement : 4 coarse sand), jointing with grey cement slurry @ 3.3 kg/ m2 including grouting the joints with epoxy of matching color , cleaning & chemical wash to remove all stains & other waste particals , etc., complete. and Specifications as per KPWD SR SL NO 9.12 VOL2 PAGE 60 , etc. complete.	SFT	1524.12		
b	GROUND FLOOR KITCHEN WALL TILES WITH 18"X12" CERAMIC TILE				
	Providing skirting, dadoing, kitchen walls ,rises of steps with colour glazed tiles 8mm thick on 10mm to 20mm thick cement plaster 1:3 and jointed with white cement slurry over existing rough plaster surface using glazed tiles of approved make,design and size, laid with spacers, including grouting the joints with epoxy of matching color , cleaning & chemical wash to remove all stains & other waste particals , cost of materials, labour, complete and Specifications as per KPWD SR SL NO 9.39 VOL2 PAGE 65 , etc. complete.	SFT	291.97		
c	TOILET FLOORING WITH 16"X16" VITRIFIED TILES				
	Providing and laying with spacers with vitrified floor tiles with thickness 9-10 mm in 16"x16" size with water absorption less than 0.08% and conforming to IS: 15622, of approved make, in all colours and shades, laid on 20mm to 40mm thick cement mortar 1:4 (1 cement : 4 coarse sand), grouting the joints with epoxy of matching color , cleaning & chemical wash to remove all stains & other waste particals , etc., complete. and Specifications as per KPWD SR SL NO 9.12 VOL2 PAGE 60 , including Scaffolding,etc. complete.				
	GROUND FLOOR	SFT	207.36		
	FIRST FLOOR	SFT	284.01		
	SECOND FLOOR	SFT	190.20		
d	TOILET WALL TILES WITH 18"X12" CERAMIC TILE				
	Providing skirting, dadoing, wall tiles, rises of steps with colour glazed tiles 8mm thick with spacers on 10mm-20mm thick cement plaster 1:3 and jointed with white cement slurry over existing rough plaster surface using glazed tiles of approved make, design and size including grouting the joints with epoxy of matching color , cleaning & chemical wash to remove all stains & other waste particals , including cost of materials, labour, complete Specifications as per KPWD SR SL NO 9.39 VOL2 PAGE 65 , including Scaffolding,etc. complete.				
	GROUND FLOOR	SFT	668.26		
	FIRST FLOOR	SFT	818.05		
	SECOND FLOOR	SFT	584.11		

12	GRANITE WORK				
i)	LIFT WALL GRANITE CLADDING				
	Providing and fixing of wall cladding using 20mm thick gang saw water cut Shiva gold granite, grey granite/Approved shade & color in CM 1:3 (1 cement : 3 coarse sand) proportion cut to required shape, pattern with paper joints, finished with cement mortal using white cement and colour pigments to match the colour of slab making through jointing with sealant, making horizontal v grooves at 3' c/c , all exposed edges provided with edge polish in joints including cleaning & acid wash & cost of all materials, mortar, labour, curing etc., complete. and Specifications as per KPWD SR SL NO 10.18 VOL2 PAGE 71, including Scaffolding etc. complete.				
a	GF WALL	SFT	88		
b	FF WALL	SFT	88		
c	SF WALL	SFT	88		
ii)	40MM THICK GRANITE PLATFORM FOR WASH BASIN & DINING HALL COUNTER SERVICE PLAT FORM				
	Providing and laying 40mm Polished Black (approved color) Granite slab Platform in required design and patterns, in linear as well as curvilinear portions of the building all complete as per the architectural drawings with 40mm Polished Black Granite slab supported by Masonary wall, with 30 mm (average) thick base of cement mortar 1:4 (1 cement : 4 coarse sand) laid and jointed with cement slurry and pointing with white cement slurry admixed with pigment of matching shade including granite slab cutting, edge finish with polish , cutting for fixing sink & filling gaps with approved sealent & finishing, rubbing, curing and polishing including cleaning & acid wash etc. all complete as specified and as directed by the Engineer-in-Charge. ** Polished Granite stone slab Black, Cat Eye, River Pink or approved. and Specifications as per KPWD SR SL NO 9.24 VOL2 PAGE 63 , including Scaffolding etc. complete.				
a	GF	SFT	37.50		
b	FF	SFT	24.00		
c	SF	SFT	16.00		
13	STRUCTURAL GLAZING CLEANING & FILLING SEALENT				
	Cleaning of structural glazing removing of dirt dust etc., using suitable cleaning powder, approved cleaning chemical using squeezers / wipers/ rubber brushes, plastic brushes, mugs, booster pumps with portable arrangement, hose pipe etc., complete including replacing Damaged Fittings , glass & filling with approved sealent for structural glazing joints & cleaning, including Scaffolding. etc, complete.				
a	GROUND FLOOR	SFT	1115.50		
b	FIRST FLOOR	SFT	1115.50		
c	SECOND FLOOR	SFT	1406.50		

14	EXTERNAL PAINTING			
	EXTERNAL PAINT : Finishing walls with 100% Premium acrylic emulsion paint having VOC less than 50 g/L and UV resistance as per IS 15489:2004, Alkali & fungal resistance, dirt resistance exterior paint of required shade (Company Depot Tinted) with silicon additives, New work (Two coats applied @ 1.43 L/ 10 m ² . Over and including priming coat of exterior primer applied @ 0.90 L/10 m ² with paint of approved quality to give an even shade, after thoroughly brooming the surface to remove all dirt, dust, mortar drops and foreign matter including preparing the surface even and sand paper smooth, cost of materials, labour complete as per specifications and as per directions of Engineer-in-charge and Specifications as per KPWD SR SL NO 8.32 VOL2 PAGE 46 , , including Scaffolding etc. complete.			
a	GROUND FLOOR	SFT	1943.39	
b	FIRST FLOOR	SFT	1564.00	
c	SECOND FLOOR	SFT	2904.00	
	DISMANTAL WORK			
1	LIFT DUCT CONCRETE CUTTING			
	Demolishing R.C.C. work manually/ by mechanical means including stacking of steel bars and disposal of unserviceable material to the appropriate disposal area as per direction of Engineer-in-charge. and Specifications as per KPWD SR SL NO 19.3 VOL2 PAGE 187 , , including Scaffolding & required centring to be provided for safety of the remaining RCC roof , repairing the damaged edges of the remaining RCC roof with cement mortar (1:3) , etc. complete.	SFT	192.00	
2	WALL TO BE REMOVED			
	Demolishing existing brick work / cement block work plastered & painted manually/ by mechanical means including stacking of serviceable material and disposal of unserviceable material to the appropriate disposal area & required centring to be provided for safety of the RCC roof , repairing the damaged edges of the remaining existing brick work / cement block work with cement mortar (1:3) ,as per direction of Engineer-in-charge. and Specifications as per KPWD SR SL NO 19.7.1 VOL2 PAGE 187) In cement mortar and Specifications as per KPWD SR SL NO 19.7.3 VOL2 PAGE 187 , including Scaffolding etc. complete.	SFT	2471.34	
3	PARKING AREA INTERLOCK BLOCKS TO BE REMOVED			
	Dismantling tile work in floors and roofs laid in cement mortar including removing cement mortar , stacking material to the appropriate disposal area & repairing the damaged edges of the existing brick work / cement block work with cement mortar (1:3) as per direction of Engineer-in-charge. and Specifications as per KPWD SR SL NO 19.22 VOL2 PAGE 189) For thickness of tiles upto 50 mm and Specifications as per KPWD SR SL NO 19.22.2 VOL2 PAGE 189 , etc. complete.	SFT	1640.00	
4	EXISTING DOORS AND WINDOWS TO BE REMOVED			

	Taking out doors, windows and clerestory window shutters (steel or wood) including stacking to the appropriate disposal area & repairing the damaged edges of the existing brick work / cement block work with cement mortar (1:3) as per direction of Engineer-in-charge and Specifications as per KPWD SR SL NO 19.13 VOL2 PAGE 188 , etc. complete.	SFT	528.75		
5	EXISTING BATH FLOORTILES TO BE REMOVED				
	Dismantling tile work in floors and roofs laid in cement mortar , including removing cement mortar , including stacking material to the appropriate disposal area as per direction of Engineer-in-charge. and Specifications as per KPWD SR SL NO 19.22 VOL2 PAGE 189) For thickness of tiles 10 mm to 25mm & repairing the damaged edges of the existing brick work / cement block work with cement mortar (1:3) and Specifications as per KPWD SR SL NO 19.22.1 VOL2 PAGE 189, etc. complete.				
a	FIRST FLOOR	SFT	81.08		
b	SECOND FLOOR	SFT	137.08		
6	EXISTING BATH WALL TILES TO BE REMOVED				
	Dismantling tile work in wall laid in cement mortar , including removing cement mortar , including stacking material to the appropriate disposal area as per direction of Engineer-in-charge. and Specifications as per KPWD SR SL NO 19.22 VOL2 PAGE 189) For thickness of tiles 10 mm to 25mm & repairing the damaged surface & edges of the existing brick work / cement block work with cement mortar (1:3) and Specifications as per KPWD SR SL NO 19.22.1 VOL2 PAGE 189, etc. complete.				
a	FIRST FLOOR	SFT	334.49		
b	SECOND FLOOR	SFT	604.49		
7	REMOVAL OF ALLUMINIUM PARTITION				
	Taking out alluminium doors, windows , partitions and including stacking to the appropriate disposal area & repairing the damaged surface & edges of the existing roof, floor , brick work / cement block work with cement mortar (1:3) as per direction of Engineer-in-charge and Specifications as per KPWD SR SL NO 19.13 VOL2 PAGE 188, etc. complete.	SFT	300.00		
8	DISMANTAL OF PLUMBING MATERIAL				
	Removing of existing old or broken 1. wash basin including tap & inlet outlet pipes, nani trap, multi trap , concealed pipes & removing supporting frame . 2. urinals including flushing system, footrest, nani trap, concealed pipes . 3. Indian Water closet including health faucet, flushing system, footrest, nani trap, concealed pipes . 4. European Water closet including health faucet ,flushing system, nani trap, concealed pipes . 5. Nanhi trap/multitrap/gully trap including concealed pipe. 6. Head & hand Shower & taps & concealed pipes & fittings per set. 7. Set of towel rods, mirror, soap tray , any other tray and granite slabs fixed in walls and disposing it with all cost and conveyance labour for all items of work, HOM with all lead and lift, loading and unloading, transportation charges and all other incidental charges				

	& repairing the damaged surface & edges of the existing roof, floor , brick work / cement block work with cement mortar (1:3) etc., complete as per specification and directions of the Engineer-in-charge of the work. and Specifications as per KPWD SR SL NO 20.123 VOL2 PAGE 209, including Scaffolding etc. complete.				
a	ALL FLOORS	NO	20		
9	SANITARY PIPE (INTERNAL & EXTERNAL)				
	Removing of existing old or damaged sanitary pipes and disposing it with all cost and conveyance labour for all items of work, HOM with all lead and lift, loading and unloading, transportation charges and all other incidental charges & repairing the damaged surface & edges of the existing roof, floor , brick work / cement block work with cement mortar (1:3) etc., complete as per specification and directions of the Engineer-in-charge of the work, including Scaffolding etc. complete.				
a	12" TO 7"	RFT	500		
b	1 1/2 " TO 6"	RFT	500		
10	WATER PIPE LINE				
	Removing of existing old or damaged water pipes and disposing it with all cost and conveyance labour for all items of work, HOM with all lead and lift, loading and unloading, transportation charges and all other incidental charges & edges of the existing roof, floor , brick work / cement block work with cement mortar (1:3) etc., complete as per specification and directions of the Engineer-in-charge of the work. including Scaffolding etc. complete.				
a	2 " TO 1"	RFT	500		
b	1/4 " TO 3/4"	RFT	500		
11	REPLASTERING OF MASONARY & RCC SURFACES				
	Providing 20 mm to 30mm cement plaster of mix :1:4 (1 cement: 4 fine sand) to brick/stone masonry/RCC surface including rounding off corners wherever required smooth rendering, providing and removing scaffolding, including cost of materials, labour, curing complete as per specifications and as per directions of Engineer-in-charge. and Specifications as per KPWD SR SL NO 8.3.1 VOL2 PAGE 41 , including Scaffolding etc. complete.	SFT	500		
12	REMOVAL OF PLASTER				
	Dismantling old plaster or skirting raking out joints and cleaning the surface for plaster including disposal of rubbish to the dumping ground to the appropriate disposal area & repairing the damaged surface & edges of the existing roof, floor , brick work / cement block work with cement mortar (1:3) as per direction of Engineer-in-charge. and Specifications as per KPWD SR SL NO 19.55 VOL2 PAGE 193, including Scaffolding etc. complete.	SFT	500		
13	DISPOSAL OF MATERIAL				

	Disposal of building rubbish / malba / similar unserviceable, dismantled or waste materials by manual/mechanical means, including loading, transporting, unloading to approved municipal dumping ground or as approved by Engineer-in-charge to the appropriate disposal area. and Specifications as per KPWD SR SL NO 19.59 VOL2 PAGE 193, etc. complete.	m3	50		
	TOTAL OF CIVIL WORK (A)				
B	PLUMBING WORK				
SL NO	ITEMS	UNIT	TOTAL QUANTITY	LABOUR & MATERIAL RATE	TOTAL MATERIAL AND LABOUR AMOUNT
	General Specifications for all plumbing works : For all plumbing work the rate includes water pressure & leakage testing , all test should be done as per IS specification for sanitary , water pipes and fittings such as Coller,Bend ,Elbows, Tees, Nipples, Plugs with cuts & threads for joint,with clamping wherever necessary, including cutting, threading, bending and similarworks, supply of clamps, Bracket, small iron structures, spacersand installation of seats, plugs, bushings etc., the rate includes cutting & making bore holes, groove cutting & making good the wall, floors , roof wherever required with cement mortar (1:3) mixed with approved water proofing compound, scaffolding, shuttering, labour, material, fixtures, fittings, etc., complete.				
1	PVC Pipe :Providing & fixing/laying PVC pipes confirming to I.S 4085-1960 & 1734-1975 of approved make (Prince/ Finolex/ Suprime) including all necessary specials like coller,bend ,Elbows, Tees,offsets, junctions, cowls, Nipples, Plugs laid under floor/under ceiling/on walls with suitable MS/PVC clamps , Bracket, with all lead and lift, including all labour and materials, fittings , fixtures, all complete as directed by EIC. including Scaffolding ,etc. complete.				
	a. 110 mm diameter (outlet for toilet, airvent, rainwater pipe, etc.)	RFT	400		
	b. 75 mm diameter (out let for floor/ urinals/ besin/Kitchen/dining hall, etc.)	RFT	500		
2	Plumbing pipes : Providing & laying conceald/open SDR 11 rated CPVC pipe s including necessary testing , confirming to I.S specification with fittings such as Coller,Bend ,Elbows, Tees, Nipples, Plugs with cuts & threads for joint,with clamping wherever necessary, including cutting, threading, bending and similarworks, supply of clamps, Bracket, small iron structures, spacersand installation of seats, plugs, bushings etc., including all labour and materials, fittings , fixtures, all lead & lift etc. complete as per specification, and as directed by engineer in charge. including Scaffolding ,etc. complete.				
	a) 22.20 mm dia	RFT	600		
	b) 28.60 mm dia	RFT	400		
	c) 41.30 mm dia	RFT	600		
3	CPVC Gate valve: Providing & fixing CPVC Gate valve confirming to IS specifications including all lead & lift , labour & material, fittings , fixtures, etc, complete as per drawings & as directed by the engineer in charge. including Scaffolding ,etc. complete.				

	a) 40 mm diameter	NO	5		
4	Supply and fixing of lever operated Forged brass/ Gun metal ball valve of approved make and provided with stainless steel ball (AISI 304) and spindle (AISI 410), glass filled teflon seating and gland packing etc., complete. The valve shall be fixed after the union. The quoted rate shall include the cost of the union, nipples , labour & material, fittings , fixtures, etc., complete. 25mm dia (Screwed ends) including Scaffolding ,etc. complete.	NO	2		
5	Supply and fixing of lever operated Forged brass/ Gun metal ball valve of approved make and provided with stainless steel ball (AISI 304) and spindle (AISI 410), glass filled teflon seating and gland packing etc., complete. The valve shall be fixed after the union. The quoted rate shall include the cost of the union, nipples, labour & material , fittings , fixtures, etc., complete. 32mm dia (Screwed ends)	NO	2		
6	EUROPEAN WATER CLOSET:- Supply and fixing of approved make glazed FLOOR mounted type European water closet , seat cover, flush valve, health faucet with angle cock, CP brass metal Bib cock . The closet to be mounted over C.I. chair bracket with flush valve consisting 32 mm dia control cock and wall flange and black or white solid seat cover of approved make with flap, rubber buffer, bolts, nuts and hinges , toilet roll holder with SS, all of approved make etc., complete. Rate includes labour , material, following fittings & A) Water closet with seat cover B) Hand Shower (Health Faucet) with 8mm Dia 1.2 Meter Long Flexible Tube and Wall Hook (C) Angle cock (D) CP brass metal Bib cock (E) flush valve (F) Brackets, etc.,	NO	10		
7	Wash basin : Supply and fixing of approved make White Coloured Under counter Wash basin (480x370x200 mm) including fixtures required to fix wash basin to wall & cost of fixing to wall and following CP brass fittings like 32mm CP waste coupling, flexible outlet pipe, 15mm CP brass long Body pillar cock with wall flange, 1 no of 15mm CP brass angular stop cock with wall flange, Nahni Trap, multi trap with grating , one no.450mm long PVC inlet connecting pipes and 40mm OD PVC waste pipe class 3 (6 Kg/cm ²) taken upto floor trap with necessary fittings , etc., complete. Rate includes following fixtures & fittings . including Scaffolding ,etc. complete. A) Under counter Wash basin size 480x370x200 B) Angle cock C) Pillar Cock D) Waste coupler E) Nahni Trap , multi trap with grating, CI Brackets, etc.,	NO	11		
8	CP brass metal Bib cock: Providing & fixing CP brass metal Bib cock with wall flange long body, conforming to IS specifications , including all lead & lift ,including labour, material, fixtures etc, complete as per drawings & as directed by the engineer in charge.	NO	12		
9	Bottle Trap : Providing and fixing Bottle Trap (with Internal Partition) 32mm size with long wall connection pipe and wall flang	NO	1		

	including labour, material, fixtures etc.all complete as per manufactrurer specification & as per direction of EIC.				
10	Towel Rail: providing and fixing approved quality chromium plated brass towel rail of 20mm dia 600mm length and 1.25mm thickness including fixing to wall with CP brass screws, finishing the same including labour, material, fixtures etc all complete as per EIC.	NO	9		
11	Soap dispenser : Providing & fixing approved quality chromium plated brass. Soap Dispenser with Glass Bottle, etc . include labour, material, fixtures, including fixing to wall with CP brass screws, finishing the same ,etc., all complete as per EIC.	NO	9		
12	Over head tank : Supplying & fixing 2000 Litres Sintex White Triple Layer Water Tank-), including all fixtures confirming to IS., with all leads & lifts, such as Coller,Bend ,Elbows, Tees, Nipples, Plugs with cuts & threads for joint,with clamping wherever necessary, including cutting, threading, bending and similarworks, supply of clamps, Bracket, small iron structures, spacersand installation of seats, plugs, bushings etc.,including labour, material, fixtures, etc., complete as per specification, drawings & as directed by Engineer in charge. including Scaffolding ,etc. complete.	NO	1		
13	Supply and fixing of GM ball cock with copper float (High pressure float) of approved brand of manufacture and fixed on to the inlet pipe at the OHT, such as Coller,Bend ,Elbows, Tees, Nipples, Plugs with cuts & threads for joint,with clamping wherever necessary, including cutting, threading, bending and similarworks, supply of clamps, Bracket, small iron structures, spacersand installation of seats, plugs, bushings etc.,including labour, material, fixtures, etc., complete.	NO	2		
14	Nahni trap : Providing & fixing nahani trap (with grating) inclusive of CP jali with hole , confirming to IS specifications with all lead & lift ,including labour, material, fixtures, etc., complete. as per specification, drawing & as directed by the Engineer in charge.	NO	27		
15	Gully trap : Providing stone ware gully trap of approved quality including cover, jali etc & fixing in C.M 1:3 wherever necessary,including labour, material, fixtures, etc., complete. as per specification, drawing & as directed by the engineer in charge. (Rate include cost of all labour, material, fixtures & lead.) Size 15x 10 cms.	NO	3		
16	Mirror : Providing and fixing round edge mirror of 6 sq.ft with 6mm thick float glass with 6mm thick water proof marine ply backing and rounded/ beveled edging , fixing on wall with wooden cleats and CP brass screws including cutting walls/ tiles , making good the same , finishing, including labour, material, fixtures, etc . all complete.	NO	11		
17	M-20 FOR BATHROOM FLOOR CONCRETE BED & OVER HEAD TANK BOTTOM BED CONCRETE				
	Providing and laying in Cement Concrete for all Basement & surface level	CFT	300.00		

	works, return walls, retaining walls, sunken floors etc. The granite/trap/ basalt crushed graded coarse aggregates and fine aggregates as per relevant IS Codes machine mixed with super plasticisers, laid in layers, well compacted using needle vibrators, providing weep holes wherever necessary, including all lead & lifts, cost of all materials of quality, labour, Usage charges of machinery, curing and all other appurtenances required to complete the work as per technical specifications. (KPWD SR SL NO 2.3 VOL1 PAGE 15) M20 Design Mix Using 20 mm nominal size graded crushed coarse aggregates and Specifications as per KPWD SR SL NO 2.3.1 VOL1 PAGE 16 , including shuttering work, etc. complete.				
18	WATER PROOFING OF BATHROOM FLOORING AND 1' WALL (Polyurethane based Single Component for Existing Surface) Providing and Applying PU based Elastomeric Liquid Applied PU Waterproofing Membrane single component, cold applied, water based acrylic PU dispersion with highly elastic and UV resistant water proofing treatment to the Existing Roof surface/Chajjas/Sunken portion of WC:Bathroom applied @ 1.2 l/per m2, having tensile strength greater than 1.5N/mm2, elongation greater than 300% with solid content not less than 60% in 2 coats including surface preparation, priming the surface with water based acrylic primer @0.1 l/m2, and spreading 60 gsm geotextile between two top coats completely as per specification. The finished cost to include surface preparation, making coving at Junction, Bore Packing, treatment of construction joints completely as per specifications as per KPWD SR SL NO 15.2 VOL2 PAGE 149 ,including labour, material, etc. complete.	CFT	500.00		
19	PLASTERING FOR BATHROOM FLOORING AND OVERHEAD TANK BED Providing 25 mm cement plaster of mix :1:4 (1 cement: 4 fine sand) to brick/stone masonry including rounding off corners wherever required smooth rendering, providing and removing scaffolding, including cost of materials, labour, curing complete as per specifications and as per directions of Engineer-in-charge.and Specifications as per KPWD SR SL NO 8.3.1 VOL2 PAGE 41 , etc. complete.	SFT	600.00		
20	6" CEMENT BLOCK WALL IN (1:4) CEMENT MORTER FOR WATER TANK BED Providing and constructing load bearing wall with Solid Concrete blocks of size 400x150x200mm having block density more than 1800kg/m3 and minimum compressive strength of 4.00 N/mm2 conforming to IS 2185 (Part - I) - 2005 and constructed with CM 1:4 as per IS 2572:2005 including cost of all materials, labour, scaffolding and curing, usage charges of machinery etc complete as				

	per specifications. and Specifications as per KPWD SR SL NO 6.33 VOL2 PAGE 17 , etc. complete.				
	TERRACE	CFT	100.00		
21	URINALS :- Providing and fixing white vitreous china flat back half stall urinal of size 580x380x350 mm with white PVC automatic flushing cistern, with fittings, standard size C.P. brass flush pipe, spreaders with unions and clamps (all in C.P. brass) with waste fitting as per IS : 2556, C.I. trap with outlet grating and other couplings in C.P. brass, including painting of fittings and cutting and making good the walls and floors wherever required, including cost of all materials, labour, fittings, fixtures, scaffolding, etc., complete. KPWD SR SL NO 14.5 VOL2 PAGE 132)	NO	6.00		
	TOTAL OF PLUMBING WORK (B)				
	TOTAL OF (A+B)				
	GST 18 %				
	GRAND TOTAL				